

Sullivan (082)
Tax Year 2026 | Reappraisal 2025

Jan 1 Owner
 COX CURTIS & NINA JEAN
 FRAZIER
 22 NELLIE BROOK DR SW
 MABLETON GA 30126

Current Owner

LOUIS ST 334

Ctrl Map: 061B Group: K Parcel: 010.00 Pl: Sl: 000

Value Information

Land Market Value: \$18,200
Improvement Value: \$79,300
Total Market Appraisal: \$97,500
Assessment Percentage: 25%
Assessment: \$24,375

Subdivision Data

Subdivision: KINGSPORT HOUSING CORP
Plat Book: 2 **Plat Page:** 51 **Block:** 4 **Lot:** 6

Additional Information

General Information

Class: 00 - Residential
City #: 380
Special Service District 1: 000
District: 11
Number of Buildings: 1
Utilities - Water/Sewer: 01 - PUBLIC / PUBLIC
Utilities - Gas/Gas Type: 01 - PUBLIC - NATURAL GAS

City: KINGSPORT
Special Service District 2: 000
Neighborhood: K01
Number of Mobile Homes: 0
Utilities - Electricity: 01 - PUBLIC
Zoning:

Outbuildings & Yard Items

Building #	Type	Description	Area/Units
1	STP - STOOP	5X20	100
1	CPY - CANOPY	5X20	100

Sale Information

Sale Date	Price	Book	Page	Vacant/Improved	Type Instrument	Qualification
8/15/1972	\$0	0383A	00013		-	-

Land Information

Deed Acres: 0 **Calculated Acres:** .18 **Total Land Units:** 0.18

Land Code	Soil Class	Units
01 - RES		0.18

Residential Building #: 1

Improvement Type: 51 - SINGLE FAMILY
Exterior Wall: 11 - COMMON BRICK
Heat and AC: 3 - RADIANT HEAT
Quality: 1 - AVERAGE
Square Feet of Living Area: 616
Foundation: 02 - CONTINUOUS FOOTING
Roof Framing: 02 - GABLE/HIP
Cabinet/Millwork: 02 - BELOW AVG
Interior Finish: 11 - PANELING BELOW AVG
Bath Tiles: 00 - NONE
Shape: 00 - SQUARE

Stories: 1.00
Actual Year Built: 1942
Plumbing Fixtures: 3
Condition: AV - AVERAGE
Floor System: 01 - SLAB ON GRADE
Roof Cover/Deck: 03 - COMPOSITION SHINGLE
Floor Finish: 07 - SHEET VINYL
Paint/Decor: 03 - AVERAGE
Electrical: 03 - AVERAGE
Structural Frame: 00 - NONE

Building Sketch

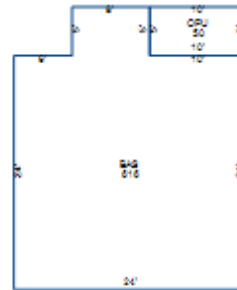

Building Areas

Areas	Square Feet
BAS - BASE	616
OPU - OPEN PORCH UNFINISHED	50