

Sullivan (082)
Tax Year 2026 | Reappraisal 2025

Jan 1 Owner
 KINGSPORT HOUSING &
 REDEVELOPMENT AUTHORITY
 671 DALE ST
 KINGSPORT TN 37660

Current Owner

LOUIS ST 218

Ctrl Map: 061B Group: L Parcel: 026.00 Pl: Sl: 000

Value Information

Land Market Value: \$14,300
Improvement Value: \$194,900
Total Market Appraisal: \$209,200
Assessment Percentage: 0%
Assessment: \$0

Subdivision Data

Subdivision: RIVERVIEW PL
Plat Book: 53 **Plat Page:** 266 **Block:** **Lot:** 26

Additional Information

BLYE MODEL

General Information

Class: 04 - Federal **City:** KINGSPORT
City #: 380 **Special Service District 2:** 000
Special Service District 1: 000 **Neighborhood:** K01
District: 11 **Number of Mobile Homes:** 0
Number of Buildings: 1 **Utilities - Electricity:** 01 - PUBLIC
Utilities - Water/Sewer: 01 - PUBLIC / PUBLIC **Zoning:**
Utilities - Gas/Gas Type: 01 - PUBLIC - NATURAL GAS

Outbuildings & Yard Items

Building #	Type	Description	Area/Units
1	PTO - PATIO	10X12	120

Sale Information

Sale Date	Price	Book	Page	Vacant/Improved	Type Instrument	Qualification
3/15/1999	\$0	1421C	24		-	-

Land Information

Deed Acres: 0 **Calculated Acres:** .14 **Total Land Units:** 0.14

Land Code	Soil Class	Units
70 - EXEMPT		0.14

Residential Building #: 1

Improvement Type: 01 - SINGLE FAMILY
Exterior Wall: 12 - BRICK/WOOD
Heat and AC: 7 - HEAT AND COOLING SPLIT
Quality: 1 - AVERAGE
Square Feet of Living Area: 1368
Foundation: 02 - CONTINUOUS FOOTING
Roof Framing: 02 - GABLE/HIP
Cabinet/Millwork: 03 - AVERAGE
Interior Finish: 07 - DRYWALL
Bath Tiles: 00 - NONE
Shape: 01 - RECTANGLE

Building Sketch

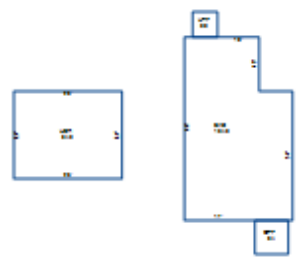

Stories:

2.00

Actual Year Built:

2011

Plumbing Fixtures:

6

Condition:

AV - AVERAGE

Floor System:

01 - SLAB ON GRADE

Roof Cover/Deck:

03 - COMPOSITION SHINGLE

Floor Finish:

11 - CARPET COMBINATION

Paint/Decor:

03 - AVERAGE

Electrical:

03 - AVERAGE

Structural Frame:

00 - NONE

Building Areas

Areas	Square Feet
BAS - BASE	1,040
UTF - UTILITY FINISHED	36
OPF - OPEN PORCH FINISHED	64
USH - UPPER STORY HIGH	546