

**Sullivan (082)**  
**Tax Year 2026 | Reappraisal 2025**

Jan 1 Owner  
 Current Owner  
 BAKER ERIC S &  
 CHELSEA SPIVEY BAKER  
 575 ORCHARD DR  
 GATE CITY VA 24251

**REDWOOD DR 1548**  
 Ctrl Map: 061F    Group: D    Parcel: 061.00    Pl:    SI: 000

**Value Information**

**Land Market Value:** \$17,200  
**Improvement Value:** \$53,300  
**Total Market Appraisal:** \$70,500  
**Assessment Percentage:** 25%  
**Assessment:** \$17,625

**Subdivision Data**

**Subdivision:**  
 CITY OF KINGSPORT  
**Plat Book:** 3    **Plat Page:** 130    **Block:** A168    **Lot:** 13

**Additional Information**

**General Information**

**Class:** 00 - Residential    **City:** KINGSPORT  
**City #:** 380    **Special Service District 2:** 000  
**Special Service District 1:** 000    **Neighborhood:** K01  
**District:** 11    **Number of Mobile Homes:** 0  
**Number of Buildings:** 1    **Utilities - Electricity:** 01 - PUBLIC  
**Utilities - Water/Sewer:** 01 - PUBLIC / PUBLIC    **Zoning:**  
**Utilities - Gas/Gas Type:** 01 - PUBLIC - NATURAL  
 GAS

**Outbuildings & Yard Items**

Building #	Type	Description	Area/Units
1	STP - STOOP	3X3	9

**Sale Information**

Long Sale Information list on subsequent pages

**Land Information**

**Deed Acres:** 0    **Calculated Acres:** .17    **Total Land Units:** 0.17

Land Code	Soil Class	Units
01 - RES		0.17

**Residential Building #: 1**

**Improvement Type:**  
 51 - SINGLE FAMILY  
**Exterior Wall:**  
 04 - SIDING AVERAGE  
**Heat and AC:**  
 7 - HEAT AND COOLING SPLIT  
**Quality:**  
 1 - - AVERAGE -  
**Square Feet of Living Area:**  
 696  
**Foundation:**  
 02 - CONTINUOUS FOOTING  
**Roof Framing:**  
 02 - GABLE/HIP  
**Cabinet/Millwork:**  
 03 - AVERAGE  
**Interior Finish:**  
 11 - PANELING BELOW AVG  
**Bath Tiles:**  
 00 - NONE  
**Shape:**  
 01 - RECTANGLE

**Building Sketch**

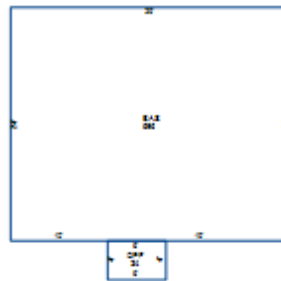

**Stories:**  
 1.00  
**Actual Year Built:**  
 1948  
**Plumbing Fixtures:**  
 3  
**Condition:**  
 AV - AVERAGE  
**Floor System:**  
 04 - WOOD W/ SUB FLOOR  
**Roof Cover/Deck:**  
 13 - PREFIN METAL CRIMPED  
**Floor Finish:**  
 11 - CARPET COMBINATION  
**Paint/Decor:**  
 03 - AVERAGE  
**Electrical:**  
 03 - AVERAGE  
**Structural Frame:**  
 00 - NONE

**Building Areas**

Areas	Square Feet
BAS - BASE	696
OPF - OPEN PORCH FINISHED	24

**Sale Information**

<b>Sale Date</b>	<b>Price</b>	<b>Book</b>	<b>Page</b>	<b>Vacant/Improved</b>	<b>Type Instrument</b>	<b>Qualification</b>
9/20/2018	\$0	3306	273		QC - QUITCLAIM DEED	-
7/30/2008	\$40,000	2693C	123	I - IMPROVED	WD - WARRANTY DEED	A - ACCEPTED
9/15/1960	\$0	0208A	00248		-	-