

Sullivan (082)
Tax Year 2026 | Reappraisal 2025

Jan 1 Owner
 HICKS JACK & LORETTA
 FAMILY TRUST
 11026 EAST SAN TAN BLDV
 SUN LAKES AZ 85248

Current Owner

NATHAN ST 2410
 Ctrl Map: 062I Group: L Parcel: 003.00 Pl: SI: 000

Value Information

Land Market Value: \$17,400
Improvement Value: \$78,100
Total Market Appraisal: \$95,500
Assessment Percentage: 25%
Assessment: \$23,875

Additional Information

General Information

Class: 00 - Residential
City #: 380
Special Service District 1: 000
District: 11
Number of Buildings: 1
Utilities - Water/Sewer: 01 - PUBLIC / PUBLIC
Utilities - Gas/Gas Type: 01 - PUBLIC - NATURAL
 GAS

City: KINGSPORT
Special Service District 2: 000
Neighborhood: K01
Number of Mobile Homes: 0
Utilities - Electricity: 01 - PUBLIC
Zoning:

Outbuildings & Yard Items

Long OutBuilding & Yard Items list on subsequent pages

Sale Information

Long Sale Information list on subsequent pages

Land Information

Deed Acres: 0 **Calculated Acres:** .24 **Total Land Units:** 0.24

| Land Code | Soil Class | Units |
|-----------|------------|-------|
| 01 - RES | | 0.24 |

Residential Building #: 1

Improvement Type:
 50 - MANUFACTURED
Exterior Wall:
 04 - SIDING AVERAGE
Heat and AC:
 7 - HEAT AND COOLING SPLIT
Quality:
 1 - AVERAGE
Square Feet of Living Area:
 1242
Foundation:
 02 - CONTINUOUS FOOTING
Roof Framing:
 02 - GABLE/HIP
Cabinet/Millwork:
 03 - AVERAGE
Interior Finish:
 07 - DRYWALL
Bath Tiles:
 00 - NONE
Shape:
 03 - U-SHAPED

Building Sketch

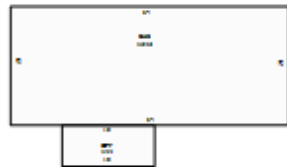

Stories:

1.00

Actual Year Built:

1994

Plumbing Fixtures:

6

Condition:

AV - AVERAGE

Floor System:

04 - WOOD W/ SUB FLOOR

Roof Cover/Deck:

13 - PREFIN METAL CRIMPED

Floor Finish:

11 - CARPET COMBINATION

Paint/Decor:

03 - AVERAGE

Electrical:

03 - AVERAGE

Structural Frame:

00 - NONE

Building Areas

| Areas | Square Feet |
|---------------------------|-------------|
| BAS - BASE | 1,242 |
| OPF - OPEN PORCH FINISHED | 144 |

Outbuildings & Yard Items

| Building # | Type | Description | Area/Units |
|------------|-----------------|-------------|------------|
| 1 | WDK - WOOD DECK | 4X6 | 24 |
| 1 | CPY - CANOPY | 22X22 | 484 |
| 1 | WDK - WOOD DECK | IRR | 156 |
| 1 | STP - STOOP | 7X8 | 56 |

Sale Information

| Sale Date | Price | Book | Page | Vacant/Improved | Type Instrument | Qualification |
|-----------|----------|-------|-------|-----------------|--------------------|---------------|
| 12/3/1993 | \$13,000 | 958C | 483 | I - IMPROVED | WD - WARRANTY DEED | A - ACCEPTED |
| 8/13/1990 | \$0 | 1004C | 314 | | - | - |
| 5/31/1969 | \$0 | 0327A | 00407 | | - | - |