

**Sullivan (082)**  
**Tax Year 2026 | Reappraisal 2025**

Jan 1 Owner  
 ARNOLD CHRISTOPHER W &  
 REBECCA L  
 1105 WIEMBLEY DR  
 KINGSPORT TN 37664

Current Owner

**WIEMBLEY DR 1105**

Ctrl Map: 062N    Group: B    Parcel: 006.00    Pl:    SI: 000

**Value Information**

**Land Market Value:** \$38,800  
**Improvement Value:** \$646,000  
**Total Market Appraisal:** \$684,800  
**Assessment Percentage:** 25%  
**Assessment:** \$171,200

**Subdivision Data**

**Subdivision:**  
 COOKS CROSSING PHASE II  
**Plat Book:** 38    **Plat Page:** 5    **Block:**    **Lot:** 59

**Additional Information**

**General Information**

**Class:** 00 - Residential    **City:** KINGSPORT  
**City #:** 380    **Special Service District 2:** 000  
**Special Service District 1:** 000    **Neighborhood:** K01  
**District:** 07    **Number of Mobile Homes:** 0  
**Number of Buildings:** 1    **Utilities - Electricity:** 01 - PUBLIC  
**Utilities - Water/Sewer:** 01 - PUBLIC / PUBLIC    **Zoning:**  
**Utilities - Gas/Gas Type:** 03 - PRIVATE - NATURAL  
 GAS

**Outbuildings & Yard Items**

Building #	Type	Description	Area/Units
1	PTO - PATIO	IRR	276

**Sale Information**

Long Sale Information list on subsequent pages

**Land Information**

**Deed Acres:** 0.44    **Calculated Acres:** .42    **Total Land Units:** 0.42

Land Code	Soil Class	Units
01 - RES		0.42

**Residential Building #: 1**

**Improvement Type:**  
 01 - SINGLE FAMILY  
**Exterior Wall:**  
 12 - BRICK/WOOD  
**Heat and AC:**  
 7 - HEAT AND COOLING SPLIT  
**Quality:**  
 1+ - AVERAGE +  
**Square Feet of Living Area:**  
 3617  
**Foundation:**  
 02 - CONTINUOUS FOOTING  
**Roof Framing:**  
 02 - GABLE/HIP  
**Cabinet/Millwork:**  
 04 - ABOVE AVG  
**Interior Finish:**  
 07 - DRYWALL  
**Bath Tiles:**  
 00 - NONE  
**Shape:**  
 01 - RECTANGLE

**Building Sketch**

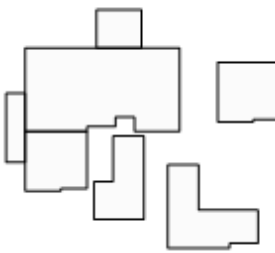

**Stories:**

2.00  
**Actual Year Built:**  
 2014  
**Plumbing Fixtures:**  
 5  
**Condition:**  
 AV - AVERAGE  
**Floor System:**  
 04 - WOOD W/ SUB FLOOR  
**Roof Cover/Deck:**  
 03 - COMPOSITION SHINGLE  
**Floor Finish:**  
 11 - CARPET COMBINATION  
**Paint/Decor:**  
 04 - ABOVE AVERAGE  
**Electrical:**  
 04 - ABOVE AVG  
**Structural Frame:**  
 00 - NONE

**Building Areas**

Areas	Square Feet
BAS - BASE	2,203
OPF - OPEN PORCH FINISHED	304
UTF - UTILITY FINISHED	128
BMU - BASEMENT UNFINISHED	128
GRF - GARAGE FINISHED	639
ATF - ATTIC FINISHED	639
UTF - UTILITY FINISHED	104
USF - UPPER STORY FINISHED	455
BMU - BASEMENT UNFINISHED	455
BMU - BASEMENT UNFINISHED	583
USF - UPPER STORY FINISHED	831

**Sale Information**

<b>Sale Date</b>	<b>Price</b>	<b>Book</b>	<b>Page</b>	<b>Vacant/Improved</b>	<b>Type Instrument</b>	<b>Qualification</b>
8/24/2018	\$460,000	3302	323	I - IMPROVED	WD - WARRANTY DEED	A - ACCEPTED
3/30/2015	\$335,000	3152	1876	I - IMPROVED	WD - WARRANTY DEED	A - ACCEPTED
4/24/2014	\$39,750	3118	145	V - VACANT	WD - WARRANTY DEED	A - ACCEPTED
8/5/1994	\$339,900	1013C	493	V - VACANT	WD - WARRANTY DEED	P - MULTIPLE PARCELS
1/11/1989	\$0	653C	413		-	-