

**Sullivan (082)**  
**Tax Year 2026 | Reappraisal 2025**

Jan 1 Owner  
 HAYNES JANICE FAYE  
 395 VALLEY DR  
 BLOUNTVILLE TN 37617

Current Owner

**VALLEY DR 395 401**  
 Ctrl Map: 064    Group:    Parcel: 085.00    Pl:    SI: 000

**Value Information**

**Land Market Value:** \$38,100  
**Improvement Value:** \$438,500  
**Total Market Appraisal:** \$476,600  
**Assessment Percentage:** 25%  
**Assessment:** \$119,150

**Subdivision Data**

**Subdivision:** MILLS ACRES SUB  
**Plat Book:** 4    **Plat Page:** 177    **Block:**    **Lot:** 19

**Additional Information**

**General Information**

**Class:** 00 - Residential    **City #:**    **City:**  
**Special Service District 1:** 000    **Special Service District 2:** 000  
**District:** 05    **Neighborhood:** V01  
**Number of Buildings:** 2    **Number of Mobile Homes:** 0  
**Utilities - Water/Sewer:** 11 - INDIVIDUAL / INDIVIDUAL    **Utilities - Electricity:** 01 - PUBLIC  
**Utilities - Gas/Gas Type:** 00 - NONE    **Zoning:** R-1

**Outbuildings & Yard Items**

Building #	Type	Description	Area/Units
2	STP - STOOP	8X16	128

**Sale Information**

Long Sale Information list on subsequent pages

**Land Information**

**Deed Acres:** 2.15    **Calculated Acres:** 0    **Total Land Units:** 2.15

Land Code	Soil Class	Units
04 - IMP SITE		2.15

**Residential Building #: 1**

**Improvement Type:** 51 - SINGLE FAMILY  
**Exterior Wall:** 04 - SIDING AVERAGE  
**Heat and AC:** 7 - HEAT AND COOLING SPLIT  
**Quality:** 1 - AVERAGE  
**Square Feet of Living Area:** 916  
**Foundation:** 02 - CONTINUOUS FOOTING  
**Roof Framing:** 02 - GABLE/HIP  
**Cabinet/Millwork:** 03 - AVERAGE  
**Interior Finish:** 07 - DRYWALL  
**Bath Tiles:** 00 - NONE  
**Shape:** 04 - IRR SHAPE

**Building Sketch**

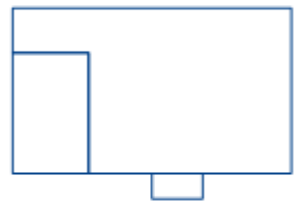

**Stories:** 1.00  
**Actual Year Built:** 1976  
**Plumbing Fixtures:** 3  
**Condition:** AV - AVERAGE  
**Floor System:** 04 - WOOD W/ SUB FLOOR  
**Roof Cover/Deck:** 13 - PREFIN METAL CRIMPED  
**Floor Finish:** 11 - CARPET COMBINATION  
**Paint/Decor:** 03 - AVERAGE  
**Electrical:** 03 - AVERAGE  
**Structural Frame:** 00 - NONE

**Building Areas**

Areas	Square Feet
BAS - BASE	916
OPF - OPEN PORCH FINISHED	32
CPF - CARPORT FINISHED	228

**Residential Building #: 2**

**Improvement Type:**

01 - SINGLE FAMILY

**Exterior Wall:**

04 - SIDING AVERAGE

**Heat and AC:**

7 - HEAT AND COOLING SPLIT

**Quality:**

1 - AVERAGE

**Square Feet of Living Area:**

1512

**Foundation:**

02 - CONTINUOUS FOOTING

**Roof Framing:**

02 - GABLE/HIP

**Cabinet/Millwork:**

03 - AVERAGE

**Interior Finish:**

07 - DRYWALL

**Bath Tiles:**

00 - NONE

**Shape:**

01 - RECTANGLE

**Building Sketch**



**Stories:**

1.00

**Actual Year Built:**

2006

**Plumbing Fixtures:**

6

**Condition:**

AV - AVERAGE

**Floor System:**

04 - WOOD W/ SUB FLOOR

**Roof Cover/Deck:**

13 - PREFIN METAL CRIMPED

**Floor Finish:**

11 - CARPET COMBINATION

**Paint/Decor:**

03 - AVERAGE

**Electrical:**

03 - AVERAGE

**Structural Frame:**

00 - NONE

**Building Areas**

Areas	Square Feet
BAS - BASE	1,512
OPF - OPEN PORCH FINISHED	240
BMU - BASEMENT UNFINISHED	1,512

**Sale Information**

<b>Sale Date</b>	<b>Price</b>	<b>Book</b>	<b>Page</b>	<b>Vacant/Improved</b>	<b>Type Instrument</b>	<b>Qualification</b>
11/16/2006	\$0	2472C	324		-	-
5/20/1999	\$0	1426C	147		-	-
11/3/1964	\$0	0251A	00515		-	-
2/10/1954	\$0	0148A	00024		-	-