

Sullivan (082)
Tax Year 2026 | Reappraisal 2025

Jan 1 Owner
 STEADMAN MARK E ETAL L/E &
 MARK E STEADMAN R/M
 702 HOLLYHILL RD
 JOHNSON CITY TN 37604

Current Owner

LOG CABIN PVT DR 3120
 Ctrl Map: 075 Group: Parcel: 056.00 Pl: SI: 000

Value Information

Land Market Value: \$361,100
Improvement Value: \$128,200
Total Market Appraisal: \$489,300

Land Use Value: \$147,500
Improvement Value: \$128,200
Total Use Appraisal: \$275,700
Assessment Percentage: 25%
Assessment: \$68,925

Additional Information

DEED 636C-505 BOUNDRY LINE AGREEMENT

General Information

Class: 11 - Agricultural
City #:
Special Service District 1: 000
District: 13
Number of Buildings: 1
Utilities - Water/Sewer: 01 - PUBLIC / PUBLIC
Utilities - Gas/Gas Type: 01 - PUBLIC - NATURAL GAS

City:
Special Service District 2: 000
Neighborhood: K03
Number of Mobile Homes: 0
Utilities - Electricity: 01 - PUBLIC
Zoning: A-1

Outbuildings & Yard Items

Long OutBuilding & Yard Items list on subsequent pages

Sale Information

Long Sale Information list on subsequent pages

Land Information

Long Land Information list on subsequent pages

Residential Building #: 1

Improvement Type:
 51 - SINGLE FAMILY
Exterior Wall:
 04 - SIDING AVERAGE
Heat and AC:
 7 - HEAT AND COOLING SPLIT
Quality:
 1- - AVERAGE -
Square Feet of Living Area:
 1021
Foundation:
 02 - CONTINUOUS FOOTING
Roof Framing:
 02 - GABLE/HIP
Cabinet/Millwork:
 02 - BELOW AVG
Interior Finish:
 04 - WOOD WALLS
Bath Tiles:
 00 - NONE
Shape:
 02 - L-SHAPED

Building Sketch

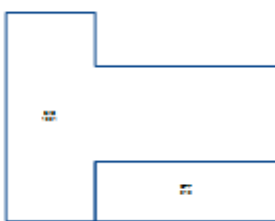

Stories:
 1.00
Actual Year Built:
 1923
Plumbing Fixtures:
 3
Condition:
 AV - AVERAGE
Floor System:
 04 - WOOD W/ SUB FLOOR
Roof Cover/Deck:
 00 - CORRUGATED METAL
Floor Finish:
 11 - CARPET COMBINATION
Paint/Decor:
 03 - AVERAGE
Electrical:
 03 - AVERAGE
Structural Frame:
 00 - NONE

Building Areas

| Areas | Square Feet |
|---------------------------|-------------|
| BAS - BASE | 1,021 |
| OPF - OPEN PORCH FINISHED | 310 |

Outbuildings & Yard Items

| Building # | Type | Description | Area/Units |
|------------|----------------------|-------------|------------|
| 1 | PBN - POLE BARN | 48X64 | 3,072 |
| 1 | PBN - POLE BARN | 39X35 | 1,365 |
| 1 | OSH - OPEN SHED | 24X48 | 72 |
| 1 | PBN - POLE BARN | 24X60 | 1,440 |
| 1 | OSH - OPEN SHED | 12X24 | 288 |
| 1 | ASH - ATTACHED SHED | 15X39 | 585 |
| 1 | ASH - ATTACHED SHED | 14X39 | 546 |
| 1 | ASH - ATTACHED SHED | 7X11 | 77 |
| 1 | ISH - IMPLEMENT SHED | 24X61 | 1,464 |

Sale Information

| Sale Date | Price | Book | Page | Vacant/Improved | Type Instrument | Qualification |
|------------|-------|-------|------|-----------------|-----------------|---------------|
| 12/18/2015 | \$0 | 3185 | 862 | | - | - |
| 12/16/2015 | \$0 | 3184 | 251 | | - | - |
| 12/20/2010 | \$0 | 2936C | 752 | | - | - |
| 1/13/2006 | \$0 | 2353C | 526 | | - | - |

Land Information

| Deed Acres: 122.64 | | Calculated Acres: 0 | | Total Land Units: 122.64 | |
|---------------------------|------------|----------------------------|--|---------------------------------|--|
| Land Code | Soil Class | Units | | | |
| 54 - PASTURE | G | 14.39 | | | |
| 54 - PASTURE | A | 12.77 | | | |
| 54 - PASTURE | P | 4.73 | | | |
| 62 - WOODLAND 2 | A | 4.80 | | | |
| 62 - WOODLAND 2 | P | 85.45 | | | |
| 04 - IMP SITE | | 0.50 | | | |