

Sullivan (082)
Tax Year 2026 | Reappraisal 2025

Jan 1 Owner
 HELTON CHARLES & DANA
 229 PARK RIDGE CT
 KINGSPORT TN 37664

Current Owner

PARK RIDGE CT 229
 Ctrl Map: 078H Group: A Parcel: 013.00 Pl: SI: 000

Value Information

Land Market Value: \$48,200
 Improvement Value: \$846,100
 Total Market Appraisal: \$894,300
 Assessment Percentage: 25%
 Assessment: \$223,575

Subdivision Data

Subdivision: PARK RIDGE ESTATES
 Plat Book: 27 Plat Page: 47 Block: A Lot: 8

Additional Information

General Information

Class: 00 - Residential City #: City:
 Special Service District 1: 000 Special Service District 2: 000
 District: 07 Neighborhood: K03
 Number of Buildings: 1 Number of Mobile Homes: 0
 Utilities - Water/Sewer: 03 - PUBLIC / INDIVIDUAL Utilities - Electricity: 01 - PUBLIC
 Utilities - Gas/Gas Type: 00 - NONE Zoning: A-1

Outbuildings & Yard Items

Long OutBuilding & Yard Items list on subsequent pages

Sale Information

Long Sale Information list on subsequent pages

Land Information

Deed Acres: 0 Calculated Acres: .9 Total Land Units: 0.9

Land Code	Soil Class	Units
01 - RES		0.90

Residential Building #: 1

Improvement Type: 03 - SPECIAL_RES
 Exterior Wall: 11 - COMMON BRICK
 Heat and AC: 7 - HEAT AND COOLING SPLIT
 Quality: 1+ - AVERAGE +
 Square Feet of Living Area: 4205
 Foundation: 02 - CONTINUOUS FOOTING
 Roof Framing: 02 - GABLE/HIP
 Cabinet/Millwork: 04 - ABOVE AVG
 Interior Finish: 07 - DRYWALL
 Bath Tiles: 00 - NONE
 Shape: 01 - RECTANGLE

Building Sketch

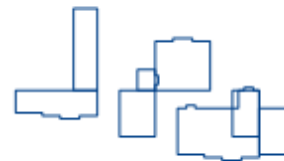

Stories: 2.00
 Actual Year Built: 1990
 Plumbing Fixtures: 11
 Condition: AV - AVERAGE
 Floor System: 04 - WOOD W/ SUB FLOOR
 Roof Cover/Deck: 03 - COMPOSITION SHINGLE
 Floor Finish: 11 - CARPET COMBINATION
 Paint/Decor: 04 - ABOVE AVERAGE
 Electrical: 04 - ABOVE AVG
 Structural Frame: 00 - NONE

Building Areas

Areas	Square Feet
BAS - BASE	1,997
USF - UPPER STORY FINISHED	180
USF - UPPER STORY FINISHED	1,247
BMF - BASEMENT FINISHED	925
GRF - GARAGE FINISHED	744
BMU - BASEMENT UNFINISHED	880
USH - UPPER STORY HIGH	744
USH - UPPER STORY HIGH	558

Outbuildings & Yard Items

Building #	Type	Description	Area/Units
1	WDK - WOOD DECK	12X27	324
1	STP - STOOP	7X10	70
1	POL - SWIMMING POOL	12X32	384
1	WDK - WOOD DECK	6X12	72

Sale Information

Sale Date	Price	Book	Page	Vacant/Improved	Type Instrument	Qualification
3/8/2017	\$341,000	3239	743	I - IMPROVED	WD - WARRANTY DEED	I - FINANCIAL INSTITUTION
5/21/2015	\$0	3158	2001		-	-
2/8/2002	\$0	1733C	287		-	-
5/25/1990	\$242,000	727C	12	V - VACANT	WD - WARRANTY DEED	M - PHYSICAL DIFFERENCE
5/9/1988	\$0	635C	532		-	-