

Sullivan (082)
Tax Year 2026 | Reappraisal 2025

Jan 1 Owner
PICKEL DONALD ELBERT &
CAROLYN
376 RYDER CHURCH RD
BLUFF CITY TN 37618

Current Owner

RYDER CHURCH RD 376
Ctrl Map: 084 Group: Parcel: 048.00 Pl: SI: 000

Value Information

Land Market Value: \$43,400
Improvement Value: \$112,600
Total Market Appraisal: \$156,000
Assessment Percentage: 25%
Assessment: \$39,000

Additional Information

General Information

Class: 00 - Residential City: Special Service District 2: 000
City #: Special Service District 1: 000 Neighborhood: R01
District: 03 Number of Mobile Homes: 0
Number of Buildings: 1 Utilities - Electricity: 01 - PUBLIC
Utilities - Water/Sewer: 11 - INDIVIDUAL / Zoning: A-1
INDIVIDUAL
Utilities - Gas/Gas Type: 00 - NONE

Outbuildings & Yard Items

Building #	Type	Description	Area/Units
1	SHD - SHED	12X18	216
1	SHD - SHED		81

Sale Information

Long Sale Information list on subsequent pages

Land Information

Deed Acres: 0 Calculated Acres: 6.5 Total Land Units: 6.51

Land Code	Soil Class	Units
04 - IMP SITE		6.51

Residential Building #: 1

Improvement Type:
51 - SINGLE FAMILY
Exterior Wall:
04 - SIDING AVERAGE
Heat and AC:
7 - HEAT AND COOLING SPLIT
Quality:
1- - AVERAGE -
Square Feet of Living Area:
1092
Foundation:
02 - CONTINUOUS FOOTING
Roof Framing:
02 - GABLE/HIP
Cabinet/Millwork:
03 - AVERAGE
Interior Finish:
07 - DRYWALL
Bath Tiles:
00 - NONE
Shape:
01 - RECTANGLE

Stories:
1.00
Actual Year Built:
1966
Plumbing Fixtures:
3
Condition:
AV - AVERAGE
Floor System:
04 - WOOD W/ SUB FLOOR
Roof Cover/Deck:
13 - PREFIN METAL CRIMPED
Floor Finish:
08 - PINE/SOFT WOOD
Paint/Decor:
03 - AVERAGE
Electrical:
03 - AVERAGE
Structural Frame:
00 - NONE

Building Sketch

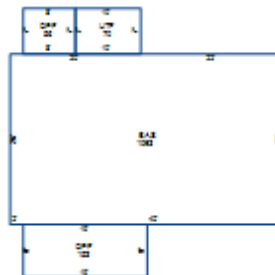

Building Areas

Areas	Square Feet
BAS - BASE	1,092
UTF - UTILITY FINISHED	70
OPF - OPEN PORCH FINISHED	56
OPF - OPEN PORCH FINISHED	152

Sale Information

Sale Date	Price	Book	Page	Vacant/Improved	Type Instrument	Qualification
2/9/2001	\$45,000	1596C	96	I - IMPROVED	WD - WARRANTY DEED	J - ESTATE SALE
7/17/1971	\$0	362A	444		-	-
8/18/1965	\$0	291A	216		-	-