

Sullivan (082)
Tax Year 2026 | Reappraisal 2025

Jan 1 Owner
 MARTIN MANDY SUE
 329 FLATWOODS RD
 BLUFF CITY TN 37618

Current Owner

FLATWOODS RD 329
 Ctrl Map: 084 Group: Parcel: 077.00 Pl: SI: 000

Value Information

Land Market Value: \$11,500
Improvement Value: \$131,300
Total Market Appraisal: \$142,800
Assessment Percentage: 25%
Assessment: \$35,700

Additional Information

General Information

Class: 00 - Residential
City #:
Special Service District 1: 000
District: 03
Number of Buildings: 1
Utilities - Water/Sewer: 03 - PUBLIC / INDIVIDUAL
Utilities - Gas/Gas Type: 00 - NONE

City:
Special Service District 2: 000
Neighborhood: R01
Number of Mobile Homes: 0
Utilities - Electricity: 01 - PUBLIC
Zoning: A-1

Outbuildings & Yard Items

Building #	Type	Description	Area/Units
1	STP - STOOP	6X15	90

Sale Information

Long Sale Information list on subsequent pages

Land Information

Deed Acres: 0	Calculated Acres: 0	Total Land Units: 0.53
Land Code	Soil Class	Units
04 - IMP SITE		0.53

Residential Building #: 1

Improvement Type:
 51 - SINGLE FAMILY
Exterior Wall:
 04 - SIDING AVERAGE
Heat and AC:
 7 - HEAT AND COOLING SPLIT
Quality:
 2 - ABOVE AVERAGE
Square Feet of Living Area:
 864
Foundation:
 02 - CONTINUOUS FOOTING
Roof Framing:
 02 - GABLE/HIP
Cabinet/Millwork:
 03 - AVERAGE
Interior Finish:
 11 - PANELING BELOW AVG
Bath Tiles:
 00 - NONE
Shape:
 01 - RECTANGLE

Stories:
 1.00
Actual Year Built:
 1946
Plumbing Fixtures:
 3
Condition:
 AV - AVERAGE
Floor System:
 04 - WOOD W/ SUB FLOOR
Roof Cover/Deck:
 13 - PREFIN METAL CRIMPED
Floor Finish:
 08 - PINE/SOFT WOOD
Paint/Decor:
 03 - AVERAGE
Electrical:
 03 - AVERAGE
Structural Frame:
 00 - NONE

Building Sketch

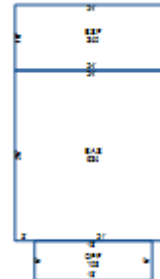

Building Areas

Areas	Square Feet
BAS - BASE	624
BSF - BASE SEMI FINISHED	240
OPF - OPEN PORCH FINISHED	108

Sale Information

Sale Date	Price	Book	Page	Vacant/Improved	Type Instrument	Qualification
11/17/2020	\$69,900	3413	897	I - IMPROVED	WD - WARRANTY DEED	A - ACCEPTED
11/12/2020	\$0	3413	893		QC - QUITCLAIM DEED	-
8/11/2011	\$0	3006	133		-	-
1/22/2007	\$0	2498C	686		-	-
7/28/2006	\$56,700	2428C	467	I - IMPROVED	WD - WARRANTY DEED	P - MULTIPLE PARCELS
5/22/2001	\$70,000	1628C	608	I - IMPROVED	WD - WARRANTY DEED	P - MULTIPLE PARCELS