

**Sullivan (082)**  
**Tax Year 2026 | Reappraisal 2025**

Jan 1 Owner  
 CLINE NATALIE M  
 2721 PRINCETON RD  
 KINGSPORT TN 37660

Current Owner

**PRINCETON RD 2721**

Ctrl Map: 090    Group:    Parcel: 095.00    Pl:    SI: 000

**Value Information**

Land Market Value: \$11,500  
 Improvement Value: \$85,300  
 Total Market Appraisal: \$96,800  
 Assessment Percentage: 25%  
 Assessment: \$24,200

**Additional Information**

**General Information**

Class: 00 - Residential  
 City #:  
 Special Service District 1: 000  
 District: 13  
 Number of Buildings: 1  
 Utilities - Water/Sewer: 03 - PUBLIC / INDIVIDUAL  
 Utilities - Gas/Gas Type: 00 - NONE

City:  
 Special Service District 2: 000  
 Neighborhood: K03  
 Number of Mobile Homes: 0  
 Utilities - Electricity: 01 - PUBLIC  
 Zoning: R-1

**Outbuildings & Yard Items**

Building #	Type	Description	Area/Units
1	SHD - SHED	17X20	340
1	WDK - WOOD DECK	7X7	49

**Sale Information**

Long Sale Information list on subsequent pages

**Land Information**

Deed Acres: 0      Calculated Acres: 0      Total Land Units: 0.51

Land Code	Soil Class	Units
04 - IMP SITE		0.51

**Residential Building #: 1**

**Improvement Type:**  
 51 - SINGLE FAMILY  
**Exterior Wall:**  
 04 - SIDING AVERAGE  
**Heat and AC:**  
 7 - HEAT AND COOLING SPLIT  
**Quality:**  
 1 - AVERAGE  
**Square Feet of Living Area:**  
 672  
**Foundation:**  
 02 - CONTINUOUS FOOTING  
**Roof Framing:**  
 02 - GABLE/HIP  
**Cabinet/Millwork:**  
 02 - BELOW AVG  
**Interior Finish:**  
 07 - DRYWALL  
**Bath Tiles:**  
 00 - NONE  
**Shape:**  
 01 - RECTANGLE

**Stories:**  
 1.00  
**Actual Year Built:**  
 1940  
**Plumbing Fixtures:**  
 3  
**Condition:**  
 AV - AVERAGE  
**Floor System:**  
 04 - WOOD W/ SUB FLOOR  
**Roof Cover/Deck:**  
 03 - COMPOSITION SHINGLE  
**Floor Finish:**  
 11 - CARPET COMBINATION  
**Paint/Decor:**  
 03 - AVERAGE  
**Electrical:**  
 02 - BELOW AVG  
**Structural Frame:**  
 00 - NONE

**Building Sketch**

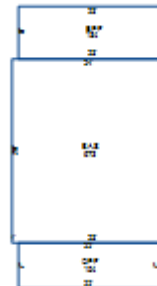

**Building Areas**

Areas	Square Feet
BAS - BASE	672
EPF - ENCLOSED PORCH FINISHED	184
OPF - OPEN PORCH FINISHED	154

**Sale Information**

<b>Sale Date</b>	<b>Price</b>	<b>Book</b>	<b>Page</b>	<b>Vacant/Improved</b>	<b>Type Instrument</b>	<b>Qualification</b>
8/20/2019	\$0	3353	1221		QC - QUITCLAIM DEED	-
4/5/2011	\$0	3003	1347		-	-
5/16/2000	\$0	1518C	359		-	-
9/24/1955	\$0	0163A	00113		-	-