

**Sullivan (082)**  
**Tax Year 2026 | Reappraisal 2025**

Jan 1 Owner  
 TAYLOR JAMES RUSSELL &  
 MARY VIRGINIA CO-TRUSTEES  
 201 ROSEHAVEN CT  
 KINGSPORT TN 37663

Current Owner

**ROSEHAVEN CT 201**  
 Ctrl Map: 092N    Group: A    Parcel: 038.70    Pl:    SI: 000

**Value Information**

**Land Market Value:** \$29,000  
**Improvement Value:** \$583,900  
**Total Market Appraisal:** \$612,900  
**Assessment Percentage:** 25%  
**Assessment:** \$153,225

**Subdivision Data**

**Subdivision:** ROSEHAVEN COURT  
**Plat Book:** 40    **Plat Page:** 32    **Block:**    **Lot:** 1

**Additional Information**

JOINT LIVING TRUST

**General Information**

**Class:** 00 - Residential    **City:** KINGSPORT  
**City #:** 380    **Special Service District 2:** 000  
**Special Service District 1:** 000    **Neighborhood:** K01  
**District:** 14    **Number of Mobile Homes:** 0  
**Utilities - Water/Sewer:** 03 - PUBLIC / INDIVIDUAL    **Utilities - Electricity:** 01 - PUBLIC  
**Utilities - Gas/Gas Type:** 00 - NONE    **Zoning:** R-1

**Outbuildings & Yard Items**

Long OutBuilding & Yard Items list on subsequent pages

**Sale Information**

Long Sale Information list on subsequent pages

**Land Information**

<b>Deed Acres:</b> 0	<b>Calculated Acres:</b> .24	<b>Total Land Units:</b> 0.24
Land Code	Soil Class	Units
01 - RES		0.24

**Residential Building #: 1**

**Improvement Type:** 03 - SPECIAL\_RES  
**Exterior Wall:** 05 - SIDING ABOVE AVG  
**Heat and AC:** 7 - HEAT AND COOLING SPLIT  
**Quality:** 1+ - AVERAGE +  
**Square Feet of Living Area:** 3295  
**Foundation:** 02 - CONTINUOUS FOOTING  
**Roof Framing:** 02 - GABLE/HIP  
**Cabinet/Millwork:** 04 - ABOVE AVG  
**Interior Finish:** 07 - DRYWALL  
**Bath Tiles:** 00 - NONE  
**Shape:** 02 - L-SHAPED

**Building Sketch**

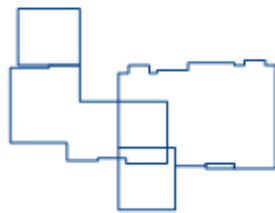

**Stories:** 2.00  
**Actual Year Built:** 1998  
**Plumbing Fixtures:** 11  
**Condition:** AV - AVERAGE  
**Floor System:** 04 - WOOD W/ SUB FLOOR  
**Roof Cover/Deck:** 03 - COMPOSITION SHINGLE  
**Floor Finish:** 11 - CARPET COMBINATION  
**Paint/Decor:** 04 - ABOVE AVERAGE  
**Electrical:** 04 - ABOVE AVG  
**Structural Frame:** 00 - NONE

**Building Areas**

Areas	Square Feet
BAS - BASE	2,219
OPF - OPEN PORCH FINISHED	22
GRF - GARAGE FINISHED	528
USH - UPPER STORY HIGH	1,617
ATF - ATTIC FINISHED	528

**Outbuildings & Yard Items**

Building #	Type	Description	Area/Units
1	POL - SWIMMING POOL	10X20	200
1	PTO - PATIO	IRR	700
1	UTB - UTILITY BUILDING	12X12	144

**Sale Information**

Sale Date	Price	Book	Page	Vacant/Improved	Type Instrument	Qualification
6/25/2025	\$0	3656	2804		QC - QUITCLAIM DEED	-
4/19/2024	\$650,000	3602	2090	I - IMPROVED	WD - WARRANTY DEED	A - ACCEPTED
4/8/2005	\$0	2241C	1		-	-
12/30/1997	\$39,000	1274C	632	V - VACANT	WD - WARRANTY DEED	L - LIMITED
8/23/1993	\$0	940C	767		-	-
7/8/1993	\$0	940C	763		-	-