

Sullivan (082)
 Tax Year 2026 | Reappraisal 2025

Jan 1 Owner
 AVERETT LESLI NICOLE &
 REESE DANIEL
 2895 B F B RD
 BLOUNTVILLE TN 37617-6345

Current Owner

B F B RD 2895

Ctrl Map: 094 Group: Parcel: 027.00 Pl: SI: 000

Value Information

Land Market Value: \$234,500 **Land Use Value:** \$75,300
Improvement Value: \$657,300 **Improvement Value:** \$657,300
Total Market Appraisal: \$891,800 **Total Use Appraisal:** \$732,600
Assessment Percentage: 25%
Assessment: \$183,150

Subdivision Data

Subdivision: RASH PROPERTY S/D
Plat Book: 57 **Plat Page:** 406 **Block:** **Lot:** 1

Additional Information

General Information

Class: 11 - Agricultural **City:**
City #: **Special Service District 2:** 000
Special Service District 1: 000 **Neighborhood:** V01
District: 18 **Number of Mobile Homes:** 0
Number of Buildings: 1 **Utilities - Electricity:** 01 - PUBLIC
Utilities - Water/Sewer: 03 - PUBLIC / INDIVIDUAL **Zoning:** P.M.D
Utilities - Gas/Gas Type: 00 - NONE

Outbuildings & Yard Items

Building #	Type	Description	Area/Units
1	PTO - PATIO	10X14	140
1	GUD - DETACHED GARAGE UNFINISHED		1,800

Sale Information

Long Sale Information list on subsequent pages

Land Information

Long Land Information list on subsequent pages

Residential Building #: 1

Improvement Type: 03 - SPECIAL_RES
Exterior Wall: 05 - SIDING ABOVE AVG
Heat and AC: 7 - HEAT AND COOLING SPLIT
Quality: 1 - AVERAGE
Square Feet of Living Area: 2750
Foundation: 02 - CONTINUOUS FOOTING
Roof Framing: 02 - GABLE/HIP
Cabinet/Millwork: 03 - AVERAGE
Interior Finish: 07 - DRYWALL
Bath Tiles: 00 - NONE
Shape: 03 - U-SHAPED

Stories: 1.00
Actual Year Built: 2022
Plumbing Fixtures: 10
Condition: AV - AVERAGE
Floor System: 01 - SLAB ON GRADE
Roof Cover/Deck: 13 - PREFIN METAL CRIMPED
Floor Finish: 11 - CARPET COMBINATION
Paint/Decor: 03 - AVERAGE
Electrical: 03 - AVERAGE
Structural Frame: 00 - NONE

Building Sketch

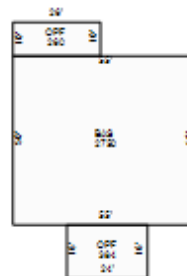

Building Areas

Areas	Square Feet
BAS - BASE	2,750
OPF - OPEN PORCH FINISHED	260
OPF - OPEN PORCH FINISHED	384

