

Sullivan (082)
Tax Year 2026 | Reappraisal 2025

Jan 1 Owner
 BASILE MARIO CARLO &
 CHRISTINA LOVE
 13720 HAMLIN BLVD
 WEST PALM BEACH FL 33412

Current Owner

REYNOLDS RD 1085

Ctrl Map: 096 Group: Parcel: 110.20 Pl: SI: 000

Value Information

Land Market Value: \$70,300
Improvement Value: \$514,600
Total Market Appraisal: \$584,900
Assessment Percentage: 25%
Assessment: \$146,225

Subdivision Data

Subdivision:
 BK 52 PG 465 LOT D
Plat Book: 52 **Plat Page:** 465 **Block:** **Lot:** D

Additional Information

0.20 AC ESMT

General Information

Class: 00 - Residential **City:**
City #: **Special Service District 2:** 000
Special Service District 1: 000 **Neighborhood:** P02
District: 08 **Number of Mobile Homes:** 0
Number of Buildings: 1 **Utilities - Electricity:** 01 - PUBLIC
Utilities - Water/Sewer: 03 - PUBLIC / INDIVIDUAL **Zoning:** A1
Utilities - Gas/Gas Type: 00 - NONE

Outbuildings & Yard Items

Long OutBuilding & Yard Items list on subsequent pages

Sale Information

Long Sale Information list on subsequent pages

Land Information

Deed Acres: 1.06 **Calculated Acres:** 0 **Total Land Units:** 1.06

Land Code	Soil Class	Units
02 - RES WAT		0.86
23 - NONPROD		0.20

Residential Building #: 1

Improvement Type:
 03 - SPECIAL_RES
Exterior Wall:
 05 - SIDING ABOVE AVG
Heat and AC:
 7 - HEAT AND COOLING SPLIT
Quality:
 1 - AVERAGE
Square Feet of Living Area:
 2123
Foundation:
 02 - CONTINUOUS FOOTING
Roof Framing:
 02 - GABLE/HIP
Cabinet/Millwork:
 04 - ABOVE AVG
Interior Finish:
 07 - DRYWALL
Bath Tiles:
 00 - NONE
Shape:
 05 - H-SHAPED

Building Sketch

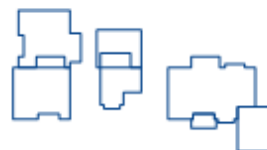

Stories:
 2.00
Actual Year Built:
 1994
Plumbing Fixtures:
 8
Condition:
 AV - AVERAGE
Floor System:
 04 - WOOD W/ SUB FLOOR
Roof Cover/Deck:
 03 - COMPOSITION SHINGLE
Floor Finish:
 11 - CARPET COMBINATION
Paint/Decor:
 04 - ABOVE AVERAGE
Electrical:
 04 - ABOVE AVG
Structural Frame:
 00 - NONE

Building Areas

Areas	Square Feet
BAS - BASE	1,451
USF - UPPER STORY FINISHED	567
BMF - BASEMENT FINISHED	988
OPF - OPEN PORCH FINISHED	106
GRF - GARAGE FINISHED	525
BMU - BASEMENT UNFINISHED	988
ATF - ATTIC FINISHED	525

Outbuildings & Yard Items

Building #	Type	Description	Area/Units
1	WDK - WOOD DECK	IRR	442
1	PTO - PATIO	IRR	634
1	WDK - WOOD DECK	20X24	480
1	BSL - BOAT SLIP	12X18	1

Sale Information

Sale Date	Price	Book	Page	Vacant/Improved	Type Instrument	Qualification
8/19/2024	\$889,000	3619	1312	I - IMPROVED	WD - WARRANTY DEED	A - ACCEPTED
2/22/2023	\$0	3546	1200		QC - QUITCLAIM DEED	-
10/7/2021	\$0	3471	1967		TE - TNNCY BY ENTIRETIES DEED	-
7/7/2021	\$570,000	3454	962	I - IMPROVED	WD - WARRANTY DEED	A - ACCEPTED
11/7/2007	\$0	2795C	379		-	-
3/8/2002	\$319,050	1743C	157	I - IMPROVED	WD - WARRANTY DEED	A - ACCEPTED
9/17/2001	\$0	1668C	390		-	-
3/14/1994	\$38,000	981C	454	V - VACANT	WD - WARRANTY DEED	A - ACCEPTED