

Sullivan (082)
Tax Year 2026 | Reappraisal 2025

Jan 1 Owner
 JOHNSON DONALD M &
 SUZANNE M
 P O BOX 3117
 BLOUNTVILLE TN 37617

Current Owner

HWY 11E 4107

Ctrl Map: 097 Group: Parcel: 011.90 Pl: SI: 000

Value Information

Land Market Value: \$503,000
Improvement Value: \$402,900
Total Market Appraisal: \$905,900
Assessment Percentage: 40%
Assessment: \$362,360

Additional Information

General Information

Class: 08 - Commercial
City #:
Special Service District 1: 000
District: 16
Number of Buildings: 12
Utilities - Water/Sewer: 03 - PUBLIC / INDIVIDUAL
Utilities - Gas/Gas Type: 03 - PRIVATE - NATURAL GAS

City:
Special Service District 2: 000
Neighborhood: Z01
Number of Mobile Homes: 0
Utilities - Electricity: 01 - PUBLIC
Zoning: B-3

Outbuildings & Yard Items

Building #	Type	Description	Area/Units
1	CNC - CONCRETE PAVING	58X70	4,060

Sale Information

Long Sale Information list on subsequent pages

Land Information

Deed Acres: 4.3 **Calculated Acres:** 0 **Total Land Units:** 4.3

Land Code	Soil Class	Units
11 - COM RURAL		4.30

Commercial Building #: 1

Improvement Type:
 40 - WAREHOUSE
Quality:
 1 - AVERAGE
Foundation:
 02 - CONTINUOUS FOOTING
Roof Framing:
 04 - WOODFRAME/TRUSS
Cabinet/Millwork:
 03 - AVERAGE
Interior Finish:
 07 - DRYWALL
Bath Tiles:
 00 - NONE
Shape:
 01 - RECTANGLE
Heat and AC:
 01 - UNIT HEATER
Building Sketch



Actual Year Built:
 1989
Business Living Area:
 3750
Floor System:
 01 - SLAB ON GRADE
Roof Cover/Deck:
 00 - CORRUGATED METAL
Floor Finish:
 01 - CONCRETE FINISH
Paint/Decor:
 03 - AVERAGE
Electrical:
 03 - AVERAGE
Structural Frame:
 00 - NONE
Plumbing Fixtures:
 2
Interior/Exterior Areas

Type	Square Feet	Exterior Wall
40 - WAREHOUSE	3,750	15 - PREFINISHED METAL

Commercial Features

Type	Units
CAW - CANOPY	400 X 1

Commercial Building #: 2

Improvement Type:

47 - PREFAB

Quality:

1 - AVERAGE

Foundation:

02 - CONTINUOUS FOOTING

Roof Framing:

04 - WOODFRAME/TRUSS

Cabinet/Millwork:

01 - MINIMUM

Interior Finish:

01 - UNFINISHED

Bath Tiles:

00 - NONE

Shape:

01 - RECTANGLE

Heat and AC:

01 - UNIT HEATER

Building Sketch



Actual Year Built:

1990

Business Living Area:

2580

Floor System:

02 - SLAB ABOVE GRADE

Roof Cover/Deck:

00 - CORRUGATED METAL

Floor Finish:

01 - CONCRETE FINISH

Paint/Decor:

01 - MINIMUM

Electrical:

02 - BELOW AVG

Structural Frame:

00 - NONE

Plumbing Fixtures:

2

Interior/Exterior Areas

Type	Square Feet	Exterior Wall
47 - PREFAB	2,580	15 - PREFINISHED METAL

Commercial Features

Type	Units
UTU - UTILITY UNFINISHED	540 X 1
OPU - OPEN PORCH UNFINISHED	588 X 1

Commercial Building #: 3

Improvement Type:

47 - PREFAB

Quality:

1 - AVERAGE

Foundation:

02 - CONTINUOUS FOOTING

Roof Framing:

04 - WOODFRAME/TRUSS

Cabinet/Millwork:

01 - MINIMUM

Interior Finish:

01 - UNFINISHED

Bath Tiles:

00 - NONE

Shape:

01 - RECTANGLE

Heat and AC:

01 - UNIT HEATER

Building Sketch

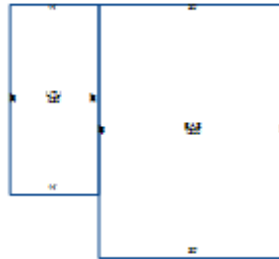

Actual Year Built:

1989

Business Living Area:

1200

Floor System:

02 - SLAB ABOVE GRADE

Roof Cover/Deck:

00 - CORRUGATED METAL

Floor Finish:

01 - CONCRETE FINISH

Paint/Decor:

01 - MINIMUM

Electrical:

01 - MINIMUM

Structural Frame:

00 - NONE

Plumbing Fixtures:

1

Interior/Exterior Areas

Type	Square Feet	Exterior Wall
47 - PREFAB	1,200	15 - PREFINISHED METAL

Commercial Features

Type	Units
UTU - UTILITY UNFINISHED	420 X 1

Commercial Building #: 4

Improvement Type:
47 - PREFAB

Quality:
1 - AVERAGE

Foundation:
02 - CONTINUOUS FOOTING

Roof Framing:
04 - WOODFRAME/TRUSS

Cabinet/Millwork:
00 - NONE

Interior Finish:
01 - UNFINISHED

Bath Tiles:
00 - NONE

Shape:
00 - SQUARE

Heat and AC:
01 - UNIT HEATER

Building Sketch

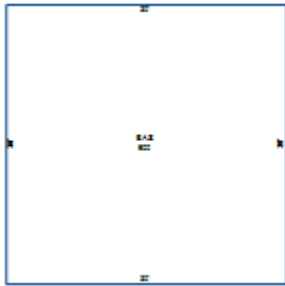

Actual Year Built:
1991

Business Living Area:
900

Floor System:
01 - SLAB ON GRADE

Roof Cover/Deck:
00 - CORRUGATED METAL

Floor Finish:
01 - CONCRETE FINISH

Paint/Decor:
00 - NONE

Electrical:
02 - BELOW AVG

Structural Frame:
01 - NONE

Plumbing Fixtures:
2

Interior/Exterior Areas

Type	Square Feet	Exterior Wall
47 - PREFAB	900	15 - PREFINISHED METAL

Commercial Features

Type	Units
------	-------

Commercial Building #: 5

Improvement Type:
47 - PREFAB

Quality:
1 - AVERAGE

Foundation:
02 - CONTINUOUS FOOTING

Roof Framing:
04 - WOODFRAME/TRUSS

Cabinet/Millwork:
00 - NONE

Interior Finish:
01 - UNFINISHED

Bath Tiles:
00 - NONE

Shape:
01 - RECTANGLE

Heat and AC:
00 - NONE

Building Sketch

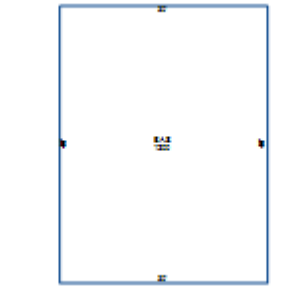

Actual Year Built:
1994

Business Living Area:
1200

Floor System:
01 - SLAB ON GRADE

Roof Cover/Deck:
00 - CORRUGATED METAL

Floor Finish:
01 - CONCRETE FINISH

Paint/Decor:
03 - AVERAGE

Electrical:
03 - AVERAGE

Structural Frame:
01 - WOOD BEAM & COLUMN

Plumbing Fixtures:
0

Interior/Exterior Areas

Type	Square Feet	Exterior Wall
47 - PREFAB	1,200	15 - PREFINISHED METAL

Commercial Features

Type	Units
------	-------

Commercial Building #: 6

Improvement Type:

47 - PREFAB

Quality:

1 - AVERAGE

Foundation:

02 - CONTINUOUS FOOTING

Roof Framing:

04 - WOODFRAME/TRUSS

Cabinet/Millwork:

00 - NONE

Interior Finish:

01 - UNFINISHED

Bath Tiles:

00 - NONE

Shape:

01 - RECTANGLE

Heat and AC:

01 - UNIT HEATER

Building Sketch



Actual Year Built:

1991

Business Living Area:

2000

Floor System:

01 - SLAB ON GRADE

Roof Cover/Deck:

00 - CORRUGATED METAL

Floor Finish:

01 - CONCRETE FINISH

Paint/Decor:

00 - NONE

Electrical:

02 - BELOW AVG

Structural Frame:

01 - NONE

Plumbing Fixtures:

2

Interior/Exterior Areas

Type	Square Feet	Exterior Wall
47 - PREFAB	2,000	15 - PREFINISHED METAL

Commercial Features

Type	Units
------	-------

Commercial Building #: 7

Improvement Type:

47 - PREFAB

Quality:

1 - AVERAGE

Foundation:

03 - SPREAD FOOTING

Roof Framing:

04 - WOODFRAME/TRUSS

Cabinet/Millwork:

00 - NONE

Interior Finish:

00 - NONE

Bath Tiles:

00 - NONE

Shape:

00 - SQUARE

Heat and AC:

01 - UNIT HEATER

Building Sketch

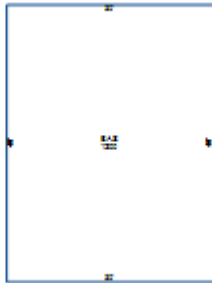

Actual Year Built:

1991

Business Living Area:

1200

Floor System:

01 - SLAB ON GRADE

Roof Cover/Deck:

00 - CORRUGATED METAL

Floor Finish:

01 - CONCRETE FINISH

Paint/Decor:

01 - MINIMUM

Electrical:

02 - BELOW AVG

Structural Frame:

01 - WOOD BEAM & COLUMN

Plumbing Fixtures:

2

Interior/Exterior Areas

Type	Square Feet	Exterior Wall
47 - PREFAB	1,200	15 - PREFINISHED METAL

Commercial Features

Type	Units
------	-------

Commercial Building #: 8

Improvement Type:

47 - PREFAB

Quality:

1 - AVERAGE

Foundation:

02 - CONTINUOUS FOOTING

Roof Framing:

04 - WOODFRAME/TRUSS

Cabinet/Millwork:

00 - NONE

Interior Finish:

01 - UNFINISHED

Bath Tiles:

00 - NONE

Shape:

01 - RECTANGLE

Heat and AC:

00 - NONE

Building Sketch



Actual Year Built:

1994

Business Living Area:

1200

Floor System:

01 - SLAB ON GRADE

Roof Cover/Deck:

00 - CORRUGATED METAL

Floor Finish:

01 - CONCRETE FINISH

Paint/Decor:

03 - AVERAGE

Electrical:

03 - AVERAGE

Structural Frame:

01 - WOOD BEAM & COLUMN

Plumbing Fixtures:

2

Interior/Exterior Areas

Type	Square Feet	Exterior Wall
47 - PREFAB	1,200	15 - PREFINISHED METAL

Commercial Features

Type	Units
------	-------

Commercial Building #: 9

Improvement Type:

47 - PREFAB

Quality:

1 - AVERAGE

Foundation:

02 - CONTINUOUS FOOTING

Roof Framing:

04 - WOODFRAME/TRUSS

Cabinet/Millwork:

00 - NONE

Interior Finish:

01 - UNFINISHED

Bath Tiles:

00 - NONE

Shape:

01 - RECTANGLE

Heat and AC:

00 - NONE

Building Sketch



Actual Year Built:

1994

Business Living Area:

1200

Floor System:

01 - SLAB ON GRADE

Roof Cover/Deck:

00 - CORRUGATED METAL

Floor Finish:

01 - CONCRETE FINISH

Paint/Decor:

03 - AVERAGE

Electrical:

00 - NONE

Structural Frame:

01 - WOOD BEAM & COLUMN

Plumbing Fixtures:

0

Interior/Exterior Areas

Type	Square Feet	Exterior Wall
47 - PREFAB	1,200	15 - PREFINISHED METAL

Commercial Features

Type	Units
------	-------

Commercial Building #: 10

Improvement Type:

47 - PREFAB

Quality:

1- - AVERAGE -

Foundation:

02 - CONTINUOUS FOOTING

Roof Framing:

00 - FLAT

Cabinet/Millwork:

00 - NONE

Interior Finish:

01 - UNFINISHED

Bath Tiles:

00 - NONE

Shape:

01 - RECTANGLE

Heat and AC:

01 - UNIT HEATER

Building Sketch

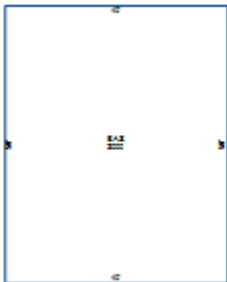

Actual Year Built:

1991

Business Living Area:

2000

Floor System:

04 - WOOD W/ SUB FLOOR

Roof Cover/Deck:

00 - CORRUGATED METAL

Floor Finish:

01 - CONCRETE FINISH

Paint/Decor:

00 - NONE

Electrical:

02 - BELOW AVG

Structural Frame:

00 - NONE

Plumbing Fixtures:

2

Interior/Exterior Areas

Type	Square Feet	Exterior Wall
47 - PREFAB	2,000	15 - PREFINISHED METAL

Commercial Features

Type	Units
------	-------

Commercial Building #: 11

Improvement Type:

40 - WAREHOUSE

Quality:

1+ - AVERAGE +

Foundation:

01 - PIERS

Roof Framing:

04 - WOODFRAME/TRUSS

Cabinet/Millwork:

00 - NONE

Interior Finish:

00 - NONE

Bath Tiles:

00 - NONE

Shape:

00 - SQUARE

Heat and AC:

00 - NONE

Building Sketch

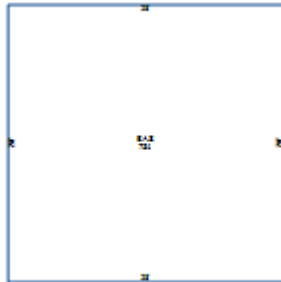

Actual Year Built:

2002

Business Living Area:

784

Floor System:

01 - SLAB ON GRADE

Roof Cover/Deck:

13 - PREFIN METAL CRIMPED

Floor Finish:

01 - CONCRETE FINISH

Paint/Decor:

03 - AVERAGE

Electrical:

00 - NONE

Structural Frame:

00 - NONE

Plumbing Fixtures:

0

Interior/Exterior Areas

Type	Square Feet	Exterior Wall
40 - WAREHOUSE	784	07 - CONCRETE BLOCK

Commercial Features

Type	Units
------	-------

Commercial Building #: 12

Improvement Type:

47 - PREFAB

Quality:

1 - AVERAGE

Foundation:

01 - PIERS

Roof Framing:

04 - WOODFRAME/TRUSS

Cabinet/Millwork:

00 - NONE

Interior Finish:

00 - NONE

Bath Tiles:

00 - NONE

Shape:

01 - RECTANGLE

Heat and AC:

00 - NONE

Building Sketch



Actual Year Built:

2004

Business Living Area:

720

Floor System:

01 - SLAB ON GRADE

Roof Cover/Deck:

13 - PREFIN METAL CRIMPED

Floor Finish:

01 - CONCRETE FINISH

Paint/Decor:

03 - AVERAGE

Electrical:

00 - NONE

Structural Frame:

01 - WOOD BEAM & COLUMN

Plumbing Fixtures:

0

Interior/Exterior Areas

Type	Square Feet	Exterior Wall
47 - PREFAB	720	19 - PREFIN METAL CRIMPED

Commercial Features

Type	Units
------	-------

Sale Information

Sale Date	Price	Book	Page	Vacant/Improved	Type Instrument	Qualification
9/8/2005	\$850,000	2303C	190	I - IMPROVED	WD - WARRANTY DEED	L - LIMITED
2/23/1989	\$0	659C	685		-	-
1/1/1900	\$0	NA	NA		-	-