

Sullivan (082)
Tax Year 2026 | Reappraisal 2025

Jan 1 Owner
 WOOMER MICHELLE
 504 CEDAR ST
 BLUFF CITY TN 37618

Current Owner

CEDAR ST 504

Ctrl Map: 097K Group: F Parcel: 006.00 Pl: SI: 000

Value Information

Land Market Value: \$12,800
 Improvement Value: \$131,400
 Total Market Appraisal: \$144,200
 Assessment Percentage: 25%
 Assessment: \$36,050

Additional Information

General Information

Class: 00 - Residential
 City #: 078
 Special Service District 1: 000
 District: 16
 Number of Buildings: 1
 Utilities - Water/Sewer: 03 - PUBLIC / INDIVIDUAL
 Utilities - Gas/Gas Type: 00 - NONE

City: BLUFF CITY
 Special Service District 2: 000
 Neighborhood: Z01
 Number of Mobile Homes: 0
 Utilities - Electricity: 01 - PUBLIC
 Zoning:

Outbuildings & Yard Items

Building #	Type	Description	Area/Units
------------	------	-------------	------------

Sale Information

Long Sale Information list on subsequent pages

Land Information

Deed Acres: 0 Calculated Acres: .3 Total Land Units: 0.3

Land Code	Soil Class	Units
01 - RES		0.30

Residential Building #: 1

Improvement Type:
 01 - SINGLE FAMILY
Exterior Wall:
 04 - SIDING AVERAGE
Heat and AC:
 8 - HEAT AND COOLING PKG
Quality:
 1- - AVERAGE -
Square Feet of Living Area:
 1464
Foundation:
 02 - CONTINUOUS FOOTING
Roof Framing:
 02 - GABLE/HIP
Cabinet/Millwork:
 02 - BELOW AVG
Interior Finish:
 07 - DRYWALL
Bath Tiles:
 00 - NONE
Shape:
 01 - RECTANGLE

Stories:
 1.00
Actual Year Built:
 1900
Plumbing Fixtures:
 3
Condition:
 AV - AVERAGE
Floor System:
 04 - WOOD W/ SUB FLOOR
Roof Cover/Deck:
 03 - COMPOSITION SHINGLE
Floor Finish:
 11 - CARPET COMBINATION
Paint/Decor:
 02 - BELOW AVERAGE
Electrical:
 03 - AVERAGE
Structural Frame:
 00 - NONE

Building Sketch

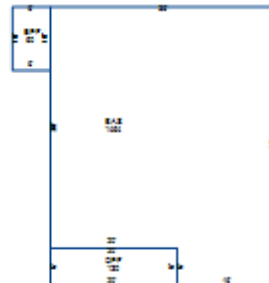

Building Areas

Areas	Square Feet
BAS - BASE	1,464
EPF - ENCLOSED PORCH FINISHED	60
OPF - OPEN PORCH FINISHED	120

Sale Information

Sale Date	Price	Book	Page	Vacant/Improved	Type Instrument	Qualification
9/3/2024	\$0	3625	677		QC - QUITCLAIM DEED	-
4/10/1987	\$28,000	551C	410		-	-
11/24/1954	\$0	155A	205		-	-