

**Sullivan (082)**  
**Tax Year 2026 | Reappraisal 2025**

Jan 1 Owner  
 GRIGORYEV ARTEM &  
 JENNIFER  
 232 HERRON DR  
 KINGSPORT TN 37663

Current Owner

**HERRON DR 232**  
 Ctrl Map: 107    Group:    Parcel: 018.00    Pl:    SI: 000

**Value Information**

**Land Market Value:** \$29,500  
**Improvement Value:** \$331,400  
**Total Market Appraisal:** \$360,900  
**Assessment Percentage:** 25%  
**Assessment:** \$90,225

**Additional Information**

**General Information**

**Class:** 00 - Residential  
**City #:**  
**Special Service District 1:** 000  
**District:** 18  
**Number of Buildings:** 1  
**Utilities - Water/Sewer:** 03 - PUBLIC / INDIVIDUAL  
**Utilities - Gas/Gas Type:** 00 - NONE

**City:**  
**Special Service District 2:** 000  
**Neighborhood:** V01  
**Number of Mobile Homes:** 0  
**Utilities - Electricity:** 01 - PUBLIC  
**Zoning:** R-1

**Outbuildings & Yard Items**

Long OutBuilding & Yard Items list on subsequent pages

**Sale Information**

Long Sale Information list on subsequent pages

**Land Information**

**Deed Acres:** 2.43      **Calculated Acres:** 0      **Total Land Units:** 2.43

Land Code	Soil Class	Units
04 - IMP SITE		2.43

**Residential Building #: 1**

**Improvement Type:**  
 01 - SINGLE FAMILY  
**Exterior Wall:**  
 11 - COMMON BRICK  
**Heat and AC:**  
 7 - HEAT AND COOLING SPLIT  
**Quality:**  
 1 - AVERAGE  
**Square Feet of Living Area:**  
 2200  
**Foundation:**  
 02 - CONTINUOUS FOOTING  
**Roof Framing:**  
 02 - GABLE/HIP  
**Cabinet/Millwork:**  
 03 - AVERAGE  
**Interior Finish:**  
 10 - PANEL-PLAST-DRYWALL  
**Bath Tiles:**  
 00 - NONE  
**Shape:**  
 00 - SQUARE

**Stories:**  
 1.00  
**Actual Year Built:**  
 1967  
**Plumbing Fixtures:**  
 8  
**Condition:**  
 AV - AVERAGE  
**Floor System:**  
 04 - WOOD W/ SUB FLOOR  
**Roof Cover/Deck:**  
 03 - COMPOSITION SHINGLE  
**Floor Finish:**  
 11 - CARPET COMBINATION  
**Paint/Decor:**  
 03 - AVERAGE  
**Electrical:**  
 03 - AVERAGE  
**Structural Frame:**  
 00 - NONE

**Building Sketch**

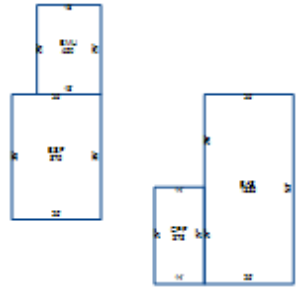

**Building Areas**

Areas	Square Feet
BAS - BASE	1,325
BSF - BASE SEMI FINISHED	875
CPF - CARPORT FINISHED	378
BMU - BASEMENT UNFINISHED	450

**Outbuildings & Yard Items**

Building #	Type	Description	Area/Units
1	PTO - PATIO	8X11	88
1	PTO - PATIO	14X26	364
1	WDK - WOOD DECK	IRR	1,182
1	PTO - PATIO	5X55	275

**Sale Information**

Sale Date	Price	Book	Page	Vacant/Improved	Type Instrument	Qualification
8/8/2022	\$365,000	3521	161	I - IMPROVED	WD - WARRANTY DEED	A - ACCEPTED
10/19/2001	\$0	1699C	528		-	-
3/20/2001	\$131,500	1600C	204	I - IMPROVED	WD - WARRANTY DEED	A - ACCEPTED
5/16/2000	\$130,000	1518C	586	I - IMPROVED	WD - WARRANTY DEED	A - ACCEPTED
7/28/1994	\$99,000	1012C	268	I - IMPROVED	WD - WARRANTY DEED	A - ACCEPTED