

Sullivan (082)
Tax Year 2026 | Reappraisal 2025

Jan 1 Owner
 KESSLER FAMILY LIMITED
 PARTNERSHIP
 624 LAKESIDE DOCK DR
 KINGSPORT TN 37663

Current Owner

HAW RIDGE DOCK RD 349

Ctrl Map: 108E Group: A Parcel: 014.00 Pl: SI: 000

Value Information

Land Market Value: \$12,200
Improvement Value: \$136,900
Total Market Appraisal: \$149,100
Assessment Percentage: 25%
Assessment: \$37,275

Additional Information

General Information

Class: 00 - Residential
City #:
Special Service District 1: 000
District: 20
Number of Buildings: 1
Utilities - Water/Sewer: 11 - INDIVIDUAL / INDIVIDUAL
Utilities - Gas/Gas Type: 00 - NONE

City:
Special Service District 2: 000
Neighborhood: P01
Number of Mobile Homes: 0
Utilities - Electricity: 01 - PUBLIC
Zoning: R-1

Outbuildings & Yard Items

Building #	Type	Description	Area/Units
------------	------	-------------	------------

Sale Information

Long Sale Information list on subsequent pages

Land Information

Deed Acres: 0	Calculated Acres: .26	Total Land Units: 0.26
Land Code	Soil Class	Units
01 - RES		0.26

Residential Building #: 1

Improvement Type:
 01 - SINGLE FAMILY
Exterior Wall:
 04 - SIDING AVERAGE
Heat and AC:
 8 - HEAT AND COOLING PKG
Quality:
 0+ - BELOW AVERAGE +
Square Feet of Living Area:
 1532
Foundation:
 02 - CONTINUOUS FOOTING
Roof Framing:
 02 - GABLE/HIP
Cabinet/Millwork:
 02 - BELOW AVG
Interior Finish:
 11 - PANELING BELOW AVG
Bath Tiles:
 00 - NONE
Shape:
 01 - RECTANGLE

Building Sketch

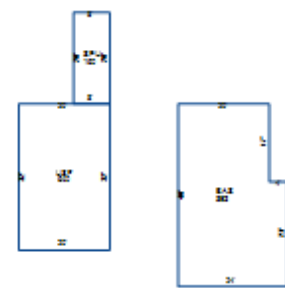

Stories:

2.00

Actual Year Built:

1976

Plumbing Fixtures:

6

Condition:

AV - AVERAGE

Floor System:

04 - WOOD W/ SUB FLOOR

Roof Cover/Deck:

03 - COMPOSITION SHINGLE

Floor Finish:

11 - CARPET COMBINATION

Paint/Decor:

02 - BELOW AVERAGE

Electrical:

03 - AVERAGE

Structural Frame:

00 - NONE

Building Areas

Areas	Square Feet
BAS - BASE	892
USF - UPPER STORY FINISHED	640
SPU - SCREEN PORCH UNFINISHED	160

Sale Information

Sale Date	Price	Book	Page	Vacant/Improved	Type Instrument	Qualification
12/29/1997	\$0	1274C	585		-	-
1/8/1990	\$0	705C	646		-	-
6/10/1982	\$0	318C	60		-	-
10/28/1975	\$0	68C	748		-	-