

Sullivan (082)
Tax Year 2026 | Reappraisal 2025

Jan 1 Owner
 PERDUE JAMES C
 2340 ENTERPRISE RD
 PINEY FLATS TN 37686

Current Owner

ENTERPRISE RD 2340
 Ctrl Map: 109D Group: C Parcel: 009.00 Pl: SI: 000

Value Information

Land Market Value: \$129,000
Improvement Value: \$695,300
Total Market Appraisal: \$824,300
Assessment Percentage: 25%
Assessment: \$206,075

Subdivision Data

Subdivision:
 W A CROSS SUB SEC 2
Plat Book: 41 **Plat Page:** 13 **Block:** **Lot:** 2

Additional Information

General Information

Class: 00 - Residential
City #:
Special Service District 1: 000
District: 20
Number of Buildings: 1
Utilities - Water/Sewer: 03 - PUBLIC / INDIVIDUAL
Utilities - Gas/Gas Type: 00 - NONE

City:
Special Service District 2: 000
Neighborhood: P01
Number of Mobile Homes: 0
Utilities - Electricity: 01 - PUBLIC
Zoning: A-1

Outbuildings & Yard Items

Long OutBuilding & Yard Items list on subsequent pages

Sale Information

Long Sale Information list on subsequent pages

Land Information

Deed Acres: 6	Calculated Acres: 0	Total Land Units: 6
Land Code	Soil Class	Units
01 - RES		6.00

Residential Building #: 1

Improvement Type:
 01 - SINGLE FAMILY
Exterior Wall:
 11 - COMMON BRICK
Heat and AC:
 7 - HEAT AND COOLING SPLIT
Quality:
 2 - ABOVE AVERAGE
Square Feet of Living Area:
 3159
Foundation:
 02 - CONTINUOUS FOOTING
Roof Framing:
 02 - GABLE/HIP
Cabinet/Millwork:
 03 - AVERAGE
Interior Finish:
 07 - DRYWALL
Bath Tiles:
 00 - NONE
Shape:
 03 - U-SHAPED

Building Sketch

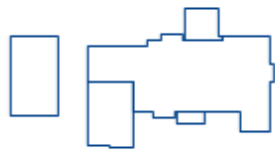

Stories:
 1.00
Actual Year Built:
 2001
Plumbing Fixtures:
 9
Condition:
 AV - AVERAGE
Floor System:
 04 - WOOD W/ SUB FLOOR
Roof Cover/Deck:
 03 - COMPOSITION SHINGLE
Floor Finish:
 11 - CARPET COMBINATION
Paint/Decor:
 04 - ABOVE AVERAGE
Electrical:
 04 - ABOVE AVG
Structural Frame:
 00 - NONE

Building Areas

Areas	Square Feet
BAS - BASE	3,159
SPF - SCREEN PORCH FINISHED	276
OPF - OPEN PORCH FINISHED	84
GRF - GARAGE FINISHED	748
BMU - BASEMENT UNFINISHED	960

Outbuildings & Yard Items

Building #	Type	Description	Area/Units
1	OSH - OPEN SHED	12X24	288
1	UTB - UTILITY BUILDING	18X24	432
1	PTO - PATIO	13X16	208

Sale Information

Sale Date	Price	Book	Page	Vacant/Improved	Type Instrument	Qualification
9/22/2023	\$845,000	3575	1853	I - IMPROVED	WD - WARRANTY DEED	A - ACCEPTED
8/25/2017	\$510,000	3256	2388	I - IMPROVED	WD - WARRANTY DEED	N - NON-ARM'S LENGTH
4/30/1998	\$55,000	1306C	643	V - VACANT	WD - WARRANTY DEED	A - ACCEPTED
8/29/1988	\$0	634C	135		-	-