

Sullivan (082)
Tax Year 2026 | Reappraisal 2025

Jan 1 Owner
 WILLIS BILLY J & LORI F
 2911 ROYAL MILE DIVIDE
 KINGSPORT TN 37664

Current Owner

ROYAL MILE DIVIDE 2911

Ctrl Map: 119H Group: C Parcel: 018.00 Pl: SI: 000

Value Information

Land Market Value: \$43,300
 Improvement Value: \$491,400
 Total Market Appraisal: \$534,700
 Assessment Percentage: 25%
 Assessment: \$133,675

Subdivision Data

Subdivision: EDINBURGH PH 2A
 Plat Book: 53 Plat Page: 339 Block: Lot: 48

Additional Information

General Information

Class: 00 - Residential City: KINGSPORT
 City #: 380 Special Service District 2: 000
 Special Service District 1: 000 Neighborhood: K01
 District: 15 Number of Mobile Homes: 0
 Number of Buildings: 1 Utilities - Electricity: 01 - PUBLIC
 Utilities - Water/Sewer: 03 - PUBLIC / INDIVIDUAL Zoning:
 Utilities - Gas/Gas Type: 00 - NONE

Outbuildings & Yard Items

| Building # | Type | Description | Area/Units |
|------------|------|-------------|------------|
|------------|------|-------------|------------|

Sale Information

Long Sale Information list on subsequent pages

Land Information

Deed Acres: 0.22 Calculated Acres: .22 Total Land Units: 0.22

| Land Code | Soil Class | Units |
|-----------|------------|-------|
| 01 - RES | | 0.22 |

Residential Building #: 1

Improvement Type: 01 - SINGLE FAMILY
 Exterior Wall: 12 - BRICK/WOOD
 Heat and AC: 7 - HEAT AND COOLING SPLIT
 Quality: 2- - ABOVE AVERAGE -
 Square Feet of Living Area: 2856
 Foundation: 02 - CONTINUOUS FOOTING
 Roof Framing: 02 - GABLE/HIP
 Cabinet/Millwork: 03 - AVERAGE
 Interior Finish: 07 - DRYWALL
 Bath Tiles: 00 - NONE
 Shape: 02 - L-SHAPED

Building Sketch

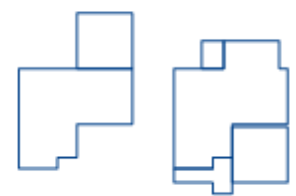

Stories:

2.00

Actual Year Built:

2012

Plumbing Fixtures:

11

Condition:

AV - AVERAGE

Floor System:

01 - SLAB ON GRADE

Roof Cover/Deck:

03 - COMPOSITION SHINGLE

Floor Finish:

11 - CARPET COMBINATION

Paint/Decor:

03 - AVERAGE

Electrical:

03 - AVERAGE

Structural Frame:

00 - NONE

Building Areas

| Areas | Square Feet |
|----------------------------|-------------|
| BAS - BASE | 1,328 |
| USF - UPPER STORY FINISHED | 1,128 |
| USF - UPPER STORY FINISHED | 400 |
| OPF - OPEN PORCH FINISHED | 80 |
| OPF - OPEN PORCH FINISHED | 161 |
| GRF - GARAGE FINISHED | 400 |

Sale Information

| Sale Date | Price | Book | Page | Vacant/Improved | Type Instrument | Qualification |
|------------------|--------------|-------------|-------------|------------------------|------------------------|----------------------|
| 11/30/2015 | \$279,500 | 3202 | 265 | I - IMPROVED | WD - WARRANTY DEED | A - ACCEPTED |
| 8/10/2012 | \$263,000 | 3046 | 1489 | I - IMPROVED | WD - WARRANTY DEED | A - ACCEPTED |
| 4/13/2011 | \$70,000 | 2965C | 52 | V - VACANT | WD - WARRANTY DEED | P - MULTIPLE PARCELS |
| 3/22/2006 | \$0 | 2378C | 420 | | - | - |