

**Sullivan (082)**  
**Tax Year 2026 | Reappraisal 2025**

Jan 1 Owner  
 DUFFY JOSEPH & STEPHANIE  
 2924 VIEWFORTH CT  
 KINGSPORT TN 37664

Current Owner

**VIEWFORTH CT 2924**

Ctrl Map: 119H    Group: H    Parcel: 014.00    Pl:    SI: 000

**Value Information**

Land Market Value: \$48,700  
 Improvement Value: \$439,700  
 Total Market Appraisal: \$488,400  
 Assessment Percentage: 25%  
 Assessment: \$122,100

**Subdivision Data**

Subdivision: EDINBURGH PH4  
 Plat Book: 54    Plat Page: 273    Block:    Lot: 129

**Additional Information**

**General Information**

Class: 00 - Residential    City: KINGSPORT  
 City #: 380    Special Service District 2: 000  
 Special Service District 1: 000    Neighborhood: K01  
 District: 15    Number of Mobile Homes: 0  
 Number of Buildings: 1    Utilities - Electricity: 01 - PUBLIC  
 Utilities - Water/Sewer: 03 - PUBLIC / INDIVIDUAL    Zoning:  
 Utilities - Gas/Gas Type: 00 - NONE

**Outbuildings & Yard Items**

Building #	Type	Description	Area/Units
1	PTO - PATIO	8X10	80

**Sale Information**

Long Sale Information list on subsequent pages

**Land Information**

Deed Acres: 0.26    Calculated Acres: .26    Total Land Units: 0.26

Land Code	Soil Class	Units
01 - RES		0.26

**Residential Building #: 1**

Improvement Type: 01 - SINGLE FAMILY  
 Exterior Wall: 04 - SIDING AVERAGE  
 Heat and AC: 7 - HEAT AND COOLING SPLIT  
 Quality: 1+ - AVERAGE +  
 Square Feet of Living Area: 2558  
 Foundation: 02 - CONTINUOUS FOOTING  
 Roof Framing: 02 - GABLE/HIP  
 Cabinet/Millwork: 03 - AVERAGE  
 Interior Finish: 07 - DRYWALL  
 Bath Tiles: 00 - NONE  
 Shape: 02 - L-SHAPED

**Building Sketch**

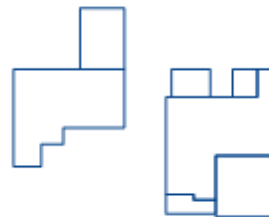

Stories: 2.00  
 Actual Year Built: 2014  
 Plumbing Fixtures: 11  
 Condition: AV - AVERAGE  
 Floor System: 04 - WOOD W/ SUB FLOOR  
 Roof Cover/Deck: 03 - COMPOSITION SHINGLE  
 Floor Finish: 11 - CARPET COMBINATION  
 Paint/Decor: 03 - AVERAGE  
 Electrical: 03 - AVERAGE  
 Structural Frame: 00 - NONE

**Building Areas**

Areas	Square Feet
BAS - BASE	1,178
USF - UPPER STORY FINISHED	1,028
USF - UPPER STORY FINISHED	352
UTF - UTILITY FINISHED	90
OPF - OPEN PORCH FINISHED	140
OPF - OPEN PORCH FINISHED	110
GRF - GARAGE FINISHED	484

**Sale Information**

<b>Sale Date</b>	<b>Price</b>	<b>Book</b>	<b>Page</b>	<b>Vacant/Improved</b>	<b>Type Instrument</b>	<b>Qualification</b>
8/8/2024	\$498,000	3618	2430	I - IMPROVED	WD - WARRANTY DEED	A - ACCEPTED
1/26/2022	\$434,500	3491	1465	I - IMPROVED	WD - WARRANTY DEED	A - ACCEPTED
4/18/2017	\$296,500	3240	1157	I - IMPROVED	WD - WARRANTY DEED	A - ACCEPTED
12/22/2014	\$277,000	3143	1068	I - IMPROVED	WD - WARRANTY DEED	A - ACCEPTED
12/11/2013	\$42,500	3104	1110	V - VACANT	WD - WARRANTY DEED	H - BUSINESS/CORPORATE SALE
3/22/2006	\$0	2378C	420		-	-