

Sullivan (082)
Tax Year 2026 | Reappraisal 2025

Jan 1 Owner
 BEGLEY RENTAL PROPERTIES
 LLC
 PO BOX 6088
 KINGSPORT TN 37663

Current Owner

FORT HENRY DR 5745

Ctrl Map: 121 Group: Parcel: 028.00 Pl: SI: 000

Value Information

Land Market Value: \$33,000
Improvement Value: \$142,500
Total Market Appraisal: \$175,500
Assessment Percentage: 40%
Assessment: \$70,200

Additional Information

General Information

Class: 08 - Commercial
City #:
Special Service District 1: 000
District: 14
Number of Buildings: 1
Utilities - Water/Sewer: 03 - PUBLIC / INDIVIDUAL
Utilities - Gas/Gas Type: 00 - NONE

City:
Special Service District 2: 000
Neighborhood: M20
Number of Mobile Homes: 0
Utilities - Electricity: 01 - PUBLIC
Zoning: B-4

Outbuildings & Yard Items

Building #	Type	Description	Area/Units
1	ASP - ASPHALT PAVING	IRR	1,650

Sale Information

Long Sale Information list on subsequent pages

Land Information

Deed Acres: 0 **Calculated Acres:** 0 **Total Land Units:** 0.32

Land Code	Soil Class	Units
10 - COM		0.32

Commercial Building #: 1

Improvement Type:

30 - OFFICE

Quality:

1+ - AVERAGE +

Foundation:

02 - CONTINUOUS FOOTING

Roof Framing:

02 - GABLE/HIP

Cabinet/Millwork:

04 - ABOVE AVG

Interior Finish:

07 - DRYWALL

Bath Tiles:

00 - NONE

Shape:

01 - RECTANGLE

Heat and AC:

08 - HVAC PKG

Building Sketch

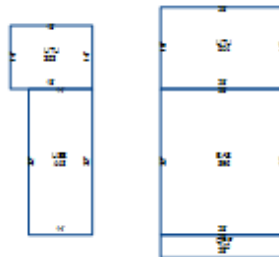

Actual Year Built:

1960

Business Living Area:

1344

Floor System:

01 - SLAB ON GRADE

Roof Cover/Deck:

03 - COMPOSITION SHINGLE

Floor Finish:

14 - HARD TILE

Paint/Decor:

04 - ABOVE AVERAGE

Electrical:

03 - AVERAGE

Structural Frame:

00 - NONE

Plumbing Fixtures:

4

Interior/Exterior Areas

Type	Square Feet	Exterior Wall
30 - OFFICE	896	04 - SIDING AVERAGE
30 - OFFICE	448	04 - SIDING AVERAGE

Commercial Features

Type	Units
OPF - OPEN PORCH FINISHED	140 X 1
UTU - UTILITY UNFINISHED	504 X 1
UTU - UTILITY UNFINISHED	252 X 1
OHD - OVERHEAD DOOR	96 X 1

Sale Information

Sale Date	Price	Book	Page	Vacant/Improved	Type Instrument	Qualification
3/4/1997	\$0	1201C	550		-	-
1/16/1997	\$0	1198C	225		-	-
12/21/1973	\$0	0015C	00618		-	-