

Sullivan (082)
Tax Year 2026 | Reappraisal 2025

Jan 1 Owner
 STONE KAREN P TRUSTEE
 489 WARREN RD
 PINEY FLATS TN 37686

Current Owner

HWY 11E 5462
 Ctrl Map: 124F Group: C Parcel: 005.00 Pl: SI: 000

Value Information

Land Market Value: \$164,900
Improvement Value: \$597,800
Total Market Appraisal: \$762,700
Assessment Percentage: 40%
Assessment: \$305,080

Additional Information

OUTSIDE CITY OF BLUFF CITY

General Information

Class: 08 - Commercial
City #:
Special Service District 1: 000
District: 09
Number of Buildings: 1
Utilities - Water/Sewer: 03 - PUBLIC / INDIVIDUAL
Utilities - Gas/Gas Type: 00 - NONE

City:
Special Service District 2: 000
Neighborhood: P20
Number of Mobile Homes: 0
Utilities - Electricity: 01 - PUBLIC
Zoning: R-1

Outbuildings & Yard Items

Building #	Type	Description	Area/Units
1	ASP - ASPHALT PAVING		1,500

Sale Information

Long Sale Information list on subsequent pages

Land Information

Deed Acres: 1.14 **Calculated Acres:** 0 **Total Land Units:** 1.14

Land Code	Soil Class	Units
10 - COM		1.14

Commercial Building #: 1

Improvement Type:
 32 - MEDICAL OFFICE
Quality:
 1+ - AVERAGE +
Foundation:
 02 - CONTINUOUS FOOTING
Roof Framing:
 06 - STEEL TRUSS/PURLINS
Cabinet/Millwork:
 03 - AVERAGE
Interior Finish:
 07 - DRYWALL
Bath Tiles:
 00 - NONE
Shape:
 01 - RECTANGLE
Heat and AC:
 08 - HVAC PKG
Building Sketch

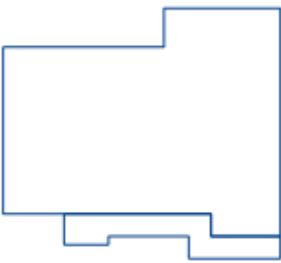

Actual Year Built:
 1982
Business Living Area:
 6788
Floor System:
 01 - SLAB ON GRADE
Roof Cover/Deck:
 13 - PREFIN METAL CRIMPED
Floor Finish:
 14 - HARD TILE
Paint/Decor:
 03 - AVERAGE
Electrical:
 03 - AVERAGE
Structural Frame:
 02 - MASONRY PIL/STL
Plumbing Fixtures:
 13
Interior/Exterior Areas

Type	Square Feet	Exterior Wall
32 - MEDICAL OFFICE	6,788	19 - PREFIN METAL CRIMPED

Commercial Features

Type	Units
OPF - OPEN PORCH FINISHED	736 X 1

Sale Information

Sale Date	Price	Book	Page	Vacant/Improved	Type Instrument	Qualification
3/21/2018	\$0	3283	327		QC - QUITCLAIM DEED	-
8/2/2007	\$0	2574C	735		-	-
2/21/1995	\$163,000	1047C	779	I - IMPROVED	WD - WARRANTY DEED	P - MULTIPLE PARCELS
5/5/1992	\$83,000	844C	61	I - IMPROVED	WD - WARRANTY DEED	A - ACCEPTED
1/2/1992	\$0	811C	751		-	-