

**Sullivan (082)**  
**Tax Year 2026 | Reappraisal 2025**

Jan 1 Owner  
 DUNBAR RICHARD & LINDA L/E &  
 MICHAEL GRINDSTAFF ETAL R/M  
 636 WOODS RD  
 BLUFF CITY TN 37618

Current Owner

**WOODS RD 636**

Ctrl Map: 125    Group:    Parcel: 115.25    Pl:    SI: 000

**Value Information**

**Land Market Value:** \$30,800  
**Improvement Value:** \$166,600  
**Total Market Appraisal:** \$197,400  
**Assessment Percentage:** 25%  
**Assessment:** \$49,350

**Subdivision Data**

**Subdivision:**  
 MARY WOODS PROP  
**Plat Book:** 58    **Plat Page:** 570    **Block:**    **Lot:** 2

**Additional Information**

**General Information**

**Class:** 00 - Residential    **City:**  
**City #:**    **Special Service District 2:** 000  
**Special Service District 1:** 000    **Neighborhood:** Z01  
**District:** 16    **Number of Mobile Homes:** 0  
**Number of Buildings:** 1    **Utilities - Electricity:** 01 - PUBLIC  
**Utilities - Water/Sewer:** 03 - PUBLIC / INDIVIDUAL    **Zoning:** A-1  
**Utilities - Gas/Gas Type:** 00 - NONE

**Outbuildings & Yard Items**

Building #	Type	Description	Area/Units
1	GUD - DETACHED GARAGE UNFINISHED	28X40	1,120
1	PBN - POLE BARN	32X50	1,600

**Sale Information**

Long Sale Information list on subsequent pages

**Land Information**

**Deed Acres:** 2.38    **Calculated Acres:** 0    **Total Land Units:** 2.38

Land Code	Soil Class	Units
04 - IMP SITE		2.38

**Residential Building #: 1**

**Improvement Type:**  
 50 - MANUFACTURED  
**Exterior Wall:**  
 04 - SIDING AVERAGE  
**Heat and AC:**  
 7 - HEAT AND COOLING SPLIT  
**Quality:**  
 1 - AVERAGE  
**Square Feet of Living Area:**  
 1080  
**Foundation:**  
 02 - CONTINUOUS FOOTING  
**Roof Framing:**  
 02 - GABLE/HIP  
**Cabinet/Millwork:**  
 03 - AVERAGE  
**Interior Finish:**  
 07 - DRYWALL  
**Bath Tiles:**  
**Shape:**  
 01 - RECTANGLE

**Building Sketch**

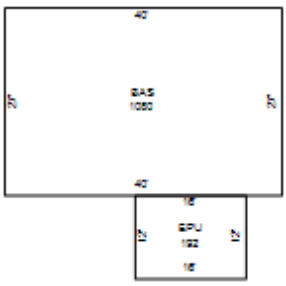

**Stories:**

1.00

**Actual Year Built:**

2003

**Plumbing Fixtures:**

6

**Condition:**

AV - AVERAGE

**Floor System:**

04 - WOOD W/ SUB FLOOR

**Roof Cover/Deck:**

13 - PREFIN METAL CRIMPED

**Floor Finish:**

11 - CARPET COMBINATION

**Paint/Decor:**

03 - AVERAGE

**Electrical:**

03 - AVERAGE

**Structural Frame:**

**Building Areas**

Areas	Square Feet
BAS - BASE	1,080
EPU - ENCLOSED PORCH UNFINISHED	192

**Sale Information**

Sale Date	Price	Book	Page	Vacant/Improved	Type Instrument	Qualification
8/29/2024	\$0	3636	1614		QC - QUITCLAIM DEED	-
5/18/2023	\$17,900	3557	1208	I - IMPROVED	WD - WARRANTY DEED	M - PHYSICAL DIFFERENCE
11/13/1989	\$0	698C	263		-	-