

Sullivan (082)
Tax Year 2026 | Reappraisal 2025

Jan 1 Owner
 JACK C SEATON TRUST
 % TONY SEATON TRUSTEE
 139 SHADY LN
 JOHNSON CITY TN 37601

Current Owner

LAKE POINT DR 500
 Ctrl Map: 140 Group: Parcel: 001.20 Pl: SI: 000

Value Information

Land Market Value: \$293,600
Improvement Value: \$962,600
Total Market Appraisal: \$1,256,200

Land Use Value: \$134,800
Improvement Value: \$962,600
Total Use Appraisal: \$1,097,400
Assessment Percentage: 25%
Assessment: \$274,350

Additional Information

General Information

Class: 11 - Agricultural
City #:
Special Service District 1: 000
District: 20
Number of Buildings: 1
Utilities - Water/Sewer: 11 - INDIVIDUAL / INDIVIDUAL
Utilities - Gas/Gas Type: 00 - NONE

City:
Special Service District 2: 000
Neighborhood: P02
Number of Mobile Homes: 0
Utilities - Electricity: 01 - PUBLIC
Zoning: R-1

Outbuildings & Yard Items

Long OutBuilding & Yard Items list on subsequent pages

Sale Information

Long Sale Information list on subsequent pages

Land Information

Long Land Information list on subsequent pages

Residential Building #: 1

Improvement Type:
 03 - SPECIAL_RES
Exterior Wall:
 18 - STONE/WOOD
Heat and AC:
 7 - HEAT AND COOLING SPLIT
Quality:
 2 - ABOVE AVERAGE
Square Feet of Living Area:
 3758
Foundation:
 02 - CONTINUOUS FOOTING
Roof Framing:
 02 - GABLE/HIP
Cabinet/Millwork:
 04 - ABOVE AVG
Interior Finish:
 07 - DRYWALL
Bath Tiles:
 00 - NONE
Shape:
 06 - EXTREME IRR

Stories:
 1.00
Actual Year Built:
 1994
Plumbing Fixtures:
 12
Condition:
 AV - AVERAGE
Floor System:
 04 - WOOD W/ SUB FLOOR
Roof Cover/Deck:
 03 - COMPOSITION SHINGLE
Floor Finish:
 11 - CARPET COMBINATION
Paint/Decor:
 04 - ABOVE AVERAGE
Electrical:
 04 - ABOVE AVG
Structural Frame:
 00 - NONE

Building Sketch

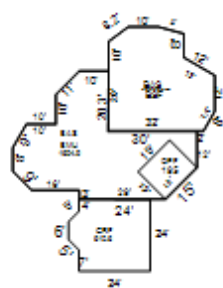

Building Areas

Areas	Square Feet
BAS - BASE	2,688
GRF - GARAGE FINISHED	611
OPF - OPEN PORCH FINISHED	195
BSF - BASE SEMI FINISHED	1,070
BMU - BASEMENT UNFINISHED	1,605

Outbuildings & Yard Items

Building #	Type	Description	Area/Units
1	WDK - WOOD DECK	IRR	432
1	PTO - PATIO	IRR	628
1	WDK - WOOD DECK	17X20	340
1	HBN - HORSE BARN	IRR	3,168
1	OSH - OPEN SHED	14X48	672
1	SHD - SHED	17X36	612
1	BSL - BOAT SLIP	16X28	1

Sale Information

Sale Date	Price	Book	Page	Vacant/Improved	Type Instrument	Qualification
1/24/2018	\$0	3274	1193		GB - GREENBELT APPLICATION	-
1/8/2018	\$0	3272	2285		GB - GREENBELT APPLICATION	-
12/19/2017	\$0	3273	155		WL - WILL BOOK	-
9/19/2000	\$0	3268	1045		QC - QUITCLAIM DEED	-
12/2/1992	\$0	879C	671		-	-
9/21/1992	\$0	879C	674		-	-
9/21/1992	\$0	871C	731		-	-
2/8/1978	\$0	153C	113		-	-

Land Information

Deed Acres: 0		Calculated Acres: 19		Total Land Units: 19	
Land Code	Soil Class	Units			
02 - RES WAT		1.00			
46 - ROTATION	G	1.21			
46 - ROTATION	A	6.34			
54 - PASTURE	A	3.67			
62 - WOODLAND 2	A	2.25			
62 - WOODLAND 2	P	4.53			