

Wilson (095)
Tax Year 2025 | Reappraisal 2021

Jan 1 Owner
 NR SN TENNESSEE A LLC
 C/O RYAN LLC
 PO BOX 4900
 SCOTTSDALE AZ 85261

Current Owner

PARK KNOLL 2857

Ctrl Map:	Group:	Parcel:	PI:	SI:
054J	D	009.00		000

Value Information

Land Market Value: \$75,000
Improvement Value: \$187,700
Total Market Appraisal: \$262,700
Assessment Percentage: 25%
Assessment: \$65,675

Subdivision Data

Subdivision:
 PARK GLEN 4
Plat Book: 24 **Plat Page:** 421 **Block:** **Lot:** 171

Additional Information

General Information

Class: 00 - Residential
City #: 508
Special Service District 1: 950
District: 01
Number of Buildings: 1
Utilities - Water/Sewer: 01 - PUBLIC / PUBLIC
Utilities - Gas/Gas Type: 01 - PUBLIC - NATURAL
 GAS

City: MT. JULIET
Special Service District 2: 000
Neighborhood: M08
Number of Mobile Homes: 0
Utilities - Electricity: 01 - PUBLIC
Zoning: RS10

Outbuildings & Yard Items

Long OutBuilding & Yard Items list on subsequent pages

Sale Information

Long Sale Information list on subsequent pages

Land Information

Deed Acres: 0 **Calculated Acres:** 0 **Total Land Units:** 1

Land Code	Soil Class	Units
01 - RES		1.00

Residential Building #: 1

Improvement Type:
 01 - SINGLE FAMILY
Exterior Wall:
 04 - SIDING AVERAGE
Heat and AC:
 7 - HEAT AND COOLING SPLIT
Quality:
 1 - AVERAGE
Square Feet of Living Area:
 1751

Stories:
 1.00
Actual Year Built:
 2003
Plumbing Fixtures:
 6
Condition:
 AV - AVERAGE

Building Sketch

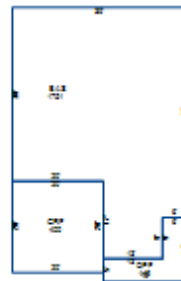

Building Areas

Areas	Square Feet
BAS - BASE	1,751
OPF - OPEN PORCH FINISHED	149
GRF - GARAGE FINISHED	400

Outbuildings & Yard Items

Building #	Type	Description	Area/Units
1	DRW - DRIVEWAY		1
1	PTO - PATIO	10X12	120
1	CMN - COMMON AREA		1

Sale Information

Sale Date	Price	Book	Page	Vacant/Improved	Type Instrument	Qualification
6/10/2022	\$416,500	2189	1611	I - IMPROVED	WD - WARRANTY DEED	J - ESTATE SALE
6/10/2022	\$0	2189	1608		HR - AFFIDAVIT OF HEIRSHIP	-
8/27/2003	\$130,496	1005	2108	I - IMPROVED	WD - WARRANTY DEED	A - ACCEPTED
6/11/2002	\$0	916	1146		-	-