

Wilson (095)
Tax Year 2025 | Reappraisal 2021

Jan 1 Owner
 USMCF SN TENNESSEE A LLC
 C/O RYAN LLC
 PO BOX 4900
 SCOTTSDALE AZ 85261

Current Owner

WOODBIDGE BLVD 1047

Ctrl Map: 094B Group: A Parcel: 040.00 Pl: SI: 014

Value Information

Land Market Value: \$36,000
Improvement Value: \$198,100
Total Market Appraisal: \$234,100
Assessment Percentage: 25%
Assessment: \$58,525

Subdivision Data

Subdivision: WOODBRIDGE GLEN SUB
Plat Book: 29 **Plat Page:** 849 **Block:** **Lot:** 521A

Additional Information

BUILDING 104

General Information

Class: 00 - Residential
City #: 404
Special Service District 1: 950
District: 22
Number of Buildings: 1
Utilities - Water/Sewer: 11 - INDIVIDUAL / INDIVIDUAL
Utilities - Gas/Gas Type: 00 - NONE

City: LEBANON
Special Service District 2: 000
Neighborhood: L38
Number of Mobile Homes: 0
Utilities - Electricity: 01 - PUBLIC
Zoning:

Outbuildings & Yard Items

Long OutBuilding & Yard Items list on subsequent pages

Sale Information

Long Sale Information list on subsequent pages

Land Information

Deed Acres: 0 **Calculated Acres:** **Total Land Units:** 1

Land Code	Soil Class	Units
01 - RES		1.00

Residential Building #: 1

Improvement Type: 08 - CONDO RES
Exterior Wall: 05 - SIDING ABOVE AVG
Heat and AC: 7 - HEAT AND COOLING SPLIT
Quality: 1 - AVERAGE
Square Feet of Living Area: 1576

Stories: 2.00
Actual Year Built: 2019
Plumbing Fixtures: 8
Condition: AV - AVERAGE

Building Sketch

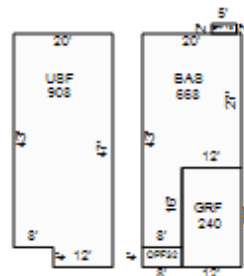

Building Areas

Areas	Square Feet
BAS - BASE	668
USF - UPPER STORY FINISHED	908
GRF - GARAGE FINISHED	240
OPF - OPEN PORCH FINISHED	32
OPF - OPEN PORCH FINISHED	10

Outbuildings & Yard Items

Building #	Type	Description	Area/Units
1	CMN - COMMON AREA		1
1	DRW - DRIVEWAY		1
1	PTO - PATIO		96

Sale Information

Sale Date	Price	Book	Page	Vacant/Improved	Type Instrument	Qualification
9/2/2021	\$270,000	2111	1529	I - IMPROVED	WD - WARRANTY DEED	A - ACCEPTED
6/25/2020	\$232,295	1973	2426	I - IMPROVED	WD - WARRANTY DEED	A - ACCEPTED
9/5/2019	\$2,729,200	1906	704	V - VACANT	WD - WARRANTY DEED	P - MULTIPLE PARCELS
12/21/2017	\$2,926,769	1800	1356	V - VACANT	WD - WARRANTY DEED	P - MULTIPLE PARCELS